

Brio ■ FALCON ■ IVES ■ LCN  
SCHLAGE ■ STEELCRAFT ■ VON DUPRIN



# Safety and security solutions

For every access point in  
your multi-family community



## Door hardware comprises but a small part of a building's architecture, yet it has a significant impact on design, functionality and the overall reputation of your multi-family building.

When choosing a door hardware solution, you must consider multiple factors, including code requirements, door type, aesthetic appeal, individuals using the opening, assets behind a door, and any other security specifications of the building.

Not every opening is the same. Securing a common area, for example, varies greatly from a maintenance or storage room. Likewise, resident spaces should be treated differently than perimeter openings. Selecting the right door hardware for a multi-family property is a delicate balance between form and function...design and durability ... and the budget and beauty of the space.

### Why Allegion?

Allegion offers a full range of security and architectural hardware solutions, from value-conscious options to high-end decorative hardware and innovative access control like mobile credentials. Our broad portfolio of hardware brands gives you multiple options for every opening, with each one providing:

- **Strength and security:** Grade 1 and 2 hardware known for long lifecycles and reliable security
- **Flexibility:** Solutions and alternatives for various applications
- **Scalability:** Variety of credentials and offline/online electronic locks to evolve with your building's needs
- **Low cost of ownership:** High-quality products that improve productivity and reduce maintenance costs
- **Service and support:** National distribution network, product training and service

At Allegion, we offer a full range of security products so you can choose the perfect solution for your building. Visit <http://us.allegion.com/multifamily> for additional multi-family solutions and resources.



Allegion offers a complete range of trusted brands

Brio ■ FALCON ■ IVES ■ LCN ■ SCHLAGE ■ STEELCRAFT ■ VON DUPRIN





Schlage Control Smart Interconnect lock



Schlage LE wireless locks

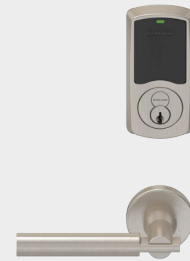

Schlage decorative trim



E

Schlage NDE wireless locks

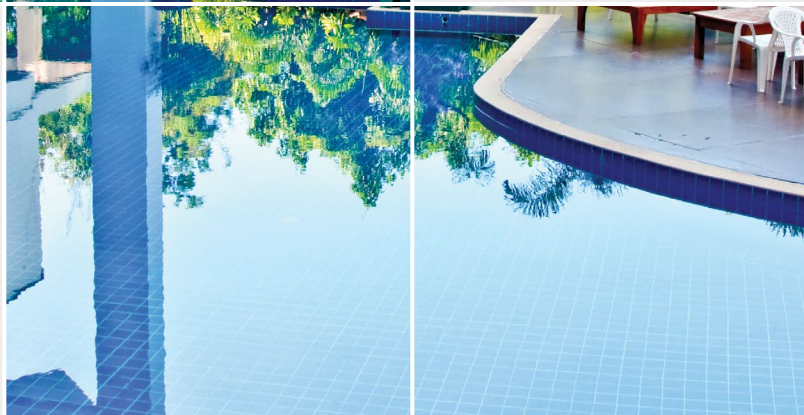

Schlage ND series keyed entry



M

## Electronic solutions

## Mechanical solutions

Schlage smart cards



Electronic locks, readers and credentials provide enhanced security levels that let you set unique levels of access rights by person. Allegion's electronic solutions are compatible with many access control software solutions so that you can choose the software platform that best lets you manage every opening in your building. Together, they offer more functionality, greater accountability and unparalleled user convenience.

**These solutions offer many benefits, including:**

- Single credential to access multiple openings
- Audit trail reports by opening and user
- Ability to limit accessibility as needed
- Elimination of rekeying costs
- Ability to cost effectively integrate with other systems
- Increased security

**Electronic access control is available in a variety of options, including the Schlage Control™ smart locks, CO Series, AD Series, NDE and LE wireless locks, as well as Schlage smart and mobile credentials.<sup>1</sup>**

<sup>1</sup> Schlage readers and credentials replace aptiQ and XceedID products. Products retain same compatibility and may be used interchangeably.

Allegion offers a variety of mechanical lock choices for every type of opening. With Full Size Interchangeable Cores (FSIC), our Schlage® locks can be easily rekeyed without disassembling the lock. And, because we understand form is as important as function, we offer locks in multiple styles and finishes to accentuate the architecture or interior design of any multi-family dwelling.

Building owners can achieve the highest level of mechanical access control with a patented key system like the Schlage Everest 29™. A patented key system prohibits the duplication of keys without the authorization of the manufacturer or its contracted locksmith vendors. By choosing a patented key system, property owners reduce risk, limit exposure and ensure the integrity of every opening.

**Mechanical solutions are available in a variety of options, including Schlage resident decorative levers, Falcon® commercial locks, and Schlage high-use commercial locks, deadbolts and Everest 29 key systems.**

Schlage deadbolt



Schlage Everest 29 patented key system





Door applications

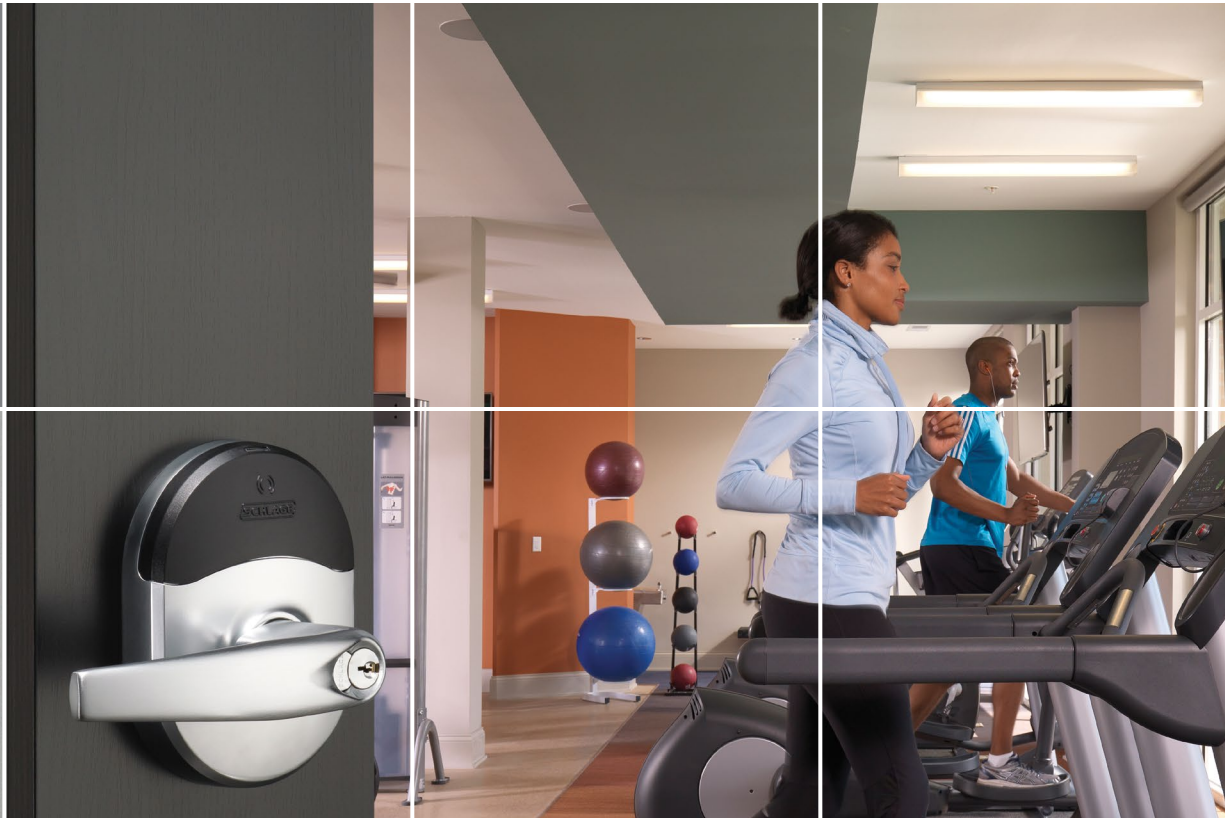

1 Main entrances

- ▣ Multi-technology reader
- ▣ Smart credential
- ▣ Von Duprin 98/99 EL exit device with trim
- ▣ LCN 4040XP closer



2 Resident entrances

- ▣ Schlage Control smart lock OR
- ▣ Schlage LE wireless lock
- ▣ Smart credential



3 Stairwells and emergency exits

- ▣ Schlage CO Series (lock or exit trim)
- ▣ Smart credential
- ▣ Falcon 25 EL exit device
- ▣ LCN 4050 closer



4 Media rooms and common areas

- ▣ Schlage ND Series OR
- ▣ Multi-technology reader
- ▣ Smart credential
- ▣ Falcon 24/25 EL exit device with trim



5 Conference centers and business offices

- ▣ Schlage NDE lock OR
- ▣ Schlage LE wireless lock
- ▣ Smart or multi-technology credential



To help identify the door solution that best fits the opening, we'll consider:

- Type of opening (traffic, abuse, environmental exposure)
- Type of door (glass, wood, fire-rated or sound-proof)
- Access control needs
- Code requirements
- Design and budgetary goals

Allegion offers a complete portfolio of solutions for every type of opening in a multi-family property:

**Main entrances**

A single credential provides access to multiple openings.

**Resident entrances**

Residents require strong and secure locks at main entrances, paired with stylish interior door hardware.

**Stairwells and emergency exits**

These openings require strong, durable door hardware that perform reliably with minimal maintenance.

**Media rooms and common areas**

With common areas, the goal is to balance ease of use with access control and proper egress compliance.

**Conference centers and business offices**

Maintaining access control and security to the rest of the building, these areas typically remain unlocked during business hours.

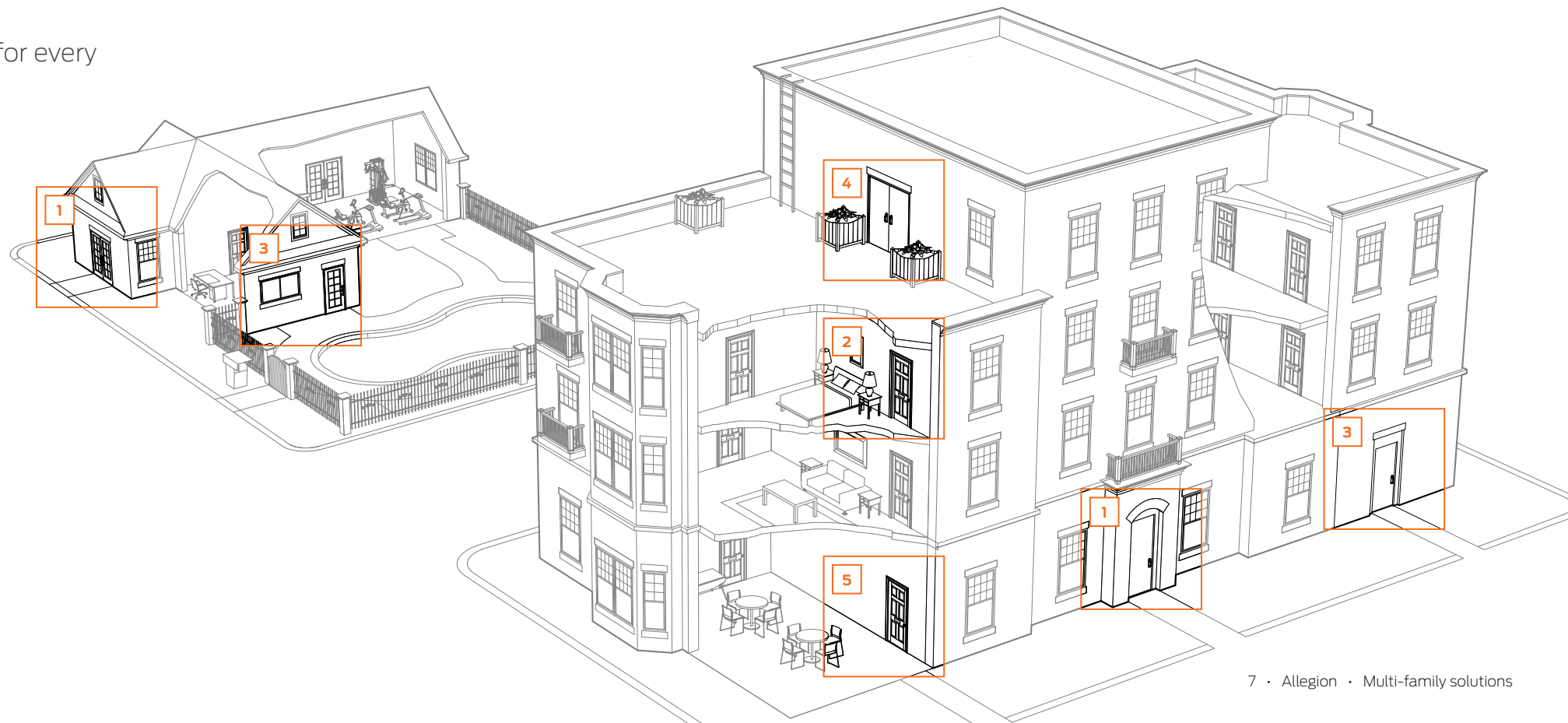



Ives decorative door pulls



Allegion has every component you need for a complete opening solution. In addition to our broad portfolio of mechanical and electronic door locks, we have a full selection of exit devices, closers, hinges, door pulls, doors and frames so you can streamline your process and specify every part of the opening all from one manufacturer with proven performance.

**Falcon locks**

- Offering includes a variety of Grade 1 and 2 cylindrical locks, a mortise lock and an interconnected lock, all designed for commercial and common area applications
- Choose from multiple functions to ensure a safe and secure door opening
- Products accept a variety of cylinder options

**Falcon closers**

- Grade 1, ADA-compliant closers for light-, medium- and heavy-duty applications
- Adjustable design providing flexible installation, reliable door control and easy maintenance
- Common hole pattern for versatile use and easy retrofit

**Falcon exit devices**

- Tough, reliable performance for every application
- Clean designs with no exposed screws or rivets on the back of the device
- Options for A or B label fire rating, electrified and panic options, and a full complement of trims

**Ives®**

- Top quality commercial door hardware that delivers application flexibility and superior value.
- Ives butt hinges, continuous hinges, and spring hinges are perfect for hanging any door in any multifamily space
- Decorative door pulls offer another design dimension with a variety of styles and finishes
- Ives offers a wide range of other accessories including flush bolts, coordinators, plates, wall stops, floor stop, exterior hardware and more

**Steelcraft doors and frames**

- Robust selection of steel doors and frames to meet your design and application needs
- Proven construction and durability
- Seamless integration with Schlage, LCN®, Von Duprin®, Falcon, Ives, and other Allegion door hardware

Complete opening solutions

Ives hinges



Steelcraft doors and frames



**FALCON** ■ **SCHLAGE**

Lever designs are subtle components of architectural design, and color and style are important aspects of any furnishing, fixture, or hardware. All elements can make a big impact in the overall feel of a space.

Similar designs between common and residential areas in a multi-family property can help to create an upscale and sophisticated environment. Falcon and Schlage have developed door hardware finishes that suite across product categories for a smooth transition between spaces.

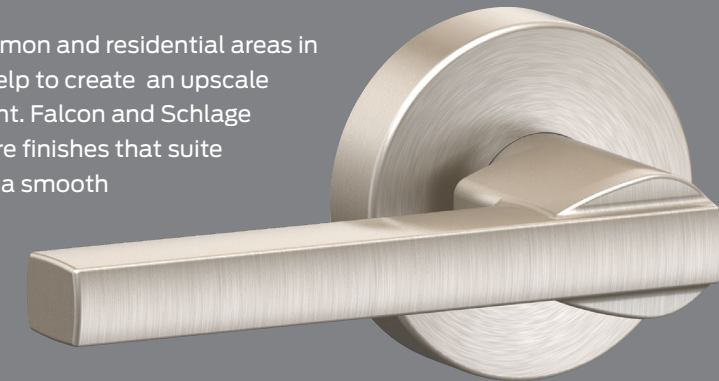

Falcon commercial hardware provides lever designs and finishes that suite with the Schlage F Series and J Series to provide a cohesive look from common areas into residential units.



Falcon 24/25 Series architectural exit device



Suited products

Falcon closers



Falcon locks

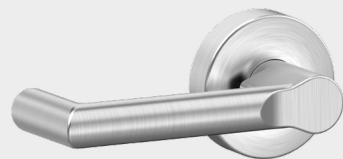

W Series small rose lever designs shown





Partnering for better solutions

Security and safety consulting services

Through partnerships with integrators and software providers, Allegion is able to better serve you and solve the unique security problems of multi-family facilities.

At Allegion, we've carefully and intentionally developed a network of trusted integration and software partners, so we provide you with a continuum of possible solutions that will help you meet your building needs and budget—for every opening.

From the most value-oriented to the most sophisticated, the solutions Allegion and our partners provide are designed to help you fully address your facility needs today, while remaining well positioned to respond to changes in the future.

**Alliance program**

Learn more about our Technology Alliance Program and our partners at <http://us.allegion.com/alliances>.

Products function only to their full potential if the right products are chosen for the job. Our team of security and safety consultants can ensure you have the right product specified for each of your openings.

With more than 100 consultants located around the country, you can be assured you'll receive guidance from a professional who is not only familiar with national building code standards but the local or regional requirements as well.

**Allegion's security and safety consultants provide an array of services, including:**

- Complete hardware specifications /RFPs
- Product/building code consulting
- Application and product reviews
- Value engineering
- Access control/credential platform consulting
- Door hardware schedules
- Job site/post-installation inspections
- Product training

**Contact an Allegion security and safety consultant.**

Contact us at 855-428-6973 to get connected with an Allegion security and safety consultant in your area. Additional resources and solutions are also available at <http://us.allegion.com/multifamily>.



## About Allegion

Allegion (NYSE: ALLE) is a global pioneer in safety and security, with leading brands like CISA®, Interflex®, LCN®, Schlage®, SimonsVoss® and Von Duprin®. Focusing on security around the door and adjacent areas, Allegion produces a range of solutions for homes, businesses, schools and other institutions. Allegion is a \$2 billion company, with products sold in almost 130 countries.

For more, visit [www.allegion.com](http://www.allegion.com)

KRYPTONITE ■ LCN ■  ■ STEELCRAFT ■ VON DUPRIN