



030091-000-70

INSTALLATION INSTRUCTIONS FOR **FALCON**® F SERIES LOCKS

1

MARK DOOR

Recommended template instructions must be followed to assure proper functioning. (See attached template). Mark height line on edge of door 38" from floor.

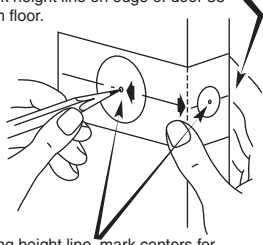

Using height line, mark centers for latch hole and side hole on both sides of door.

2

BORE 3 HOLES

A. Bore side hole from both sides of door.

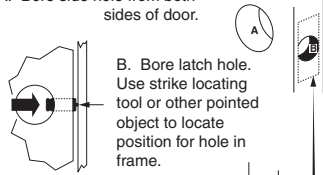

B. Bore latch hole. Use strike locating tool or other pointed object to locate position for hole in frame.

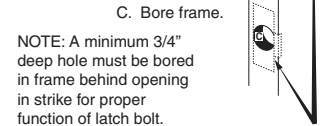

C. Bore frame.

NOTE: A minimum 3/4" deep hole must be bored in frame behind opening in strike for proper function of latch bolt.

Outline latch face and strike as illustrated and chisel out to proper depth.

3

INSTALL LATCH AND STRIKE

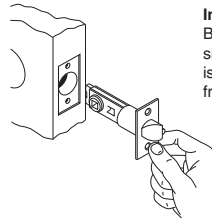

Install latch.
Be sure beveled side of latch bolt is facing the door frame.

Install strike.
If dust box is to be used, clear area with wood chisel.

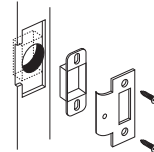

4

REMOVE INSIDE TRIM

Depress locking button to remove knob or lever. *

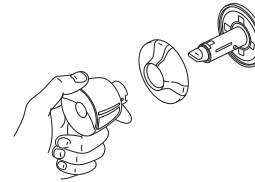

Pull knob or lever off of spindle. Unsnap rose from mounting plate. It will be necessary to pry the rose with a very thin flat screwdriver, nail or other thin object. Pry under or near the tiny depressions on the edge of the rose and remove from spindle.

* If cylinder knob or lever, see below.

5

INSTALL OUTSIDE KNOB OR LEVER

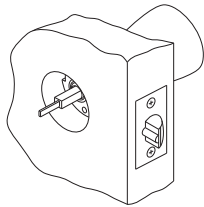

Insert outside trim thru center of latch. Hold flush against door.

IMPORTANT NOTE:
When opening outer trim by key, always mount through latch hub to avoid misalignment.

6

INSTALL INSIDE ASSEMBLY

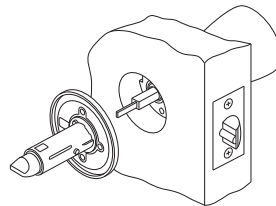

Slide inside assembly over locking bar; insert and evenly tighten machine screws.

Note: Locking button in lever locks must be positioned towards the edge of the door.

7

INSTALL ROSE AND KNOB OR LEVER

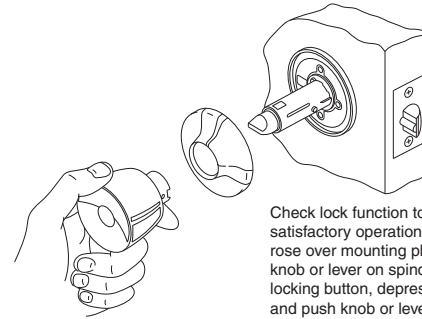

Check lock function to verify satisfactory operation. Snap rose over mounting plate. Place knob or lever on spindle, slide to locking button, depress button and push knob or lever until button engages hole.

INSTRUCTIONS FOR KNOBS WITH CYLINDERS

CYLINDER KNOB SHOULD BE INSTALLED WITH KEY NOTCHES UP AS SHOWN

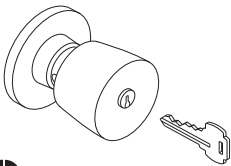

INSTRUCTIONS FOR REMOVAL AND REASSEMBLY OF CYLINDER KNOB

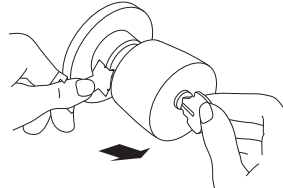

With key, unlock lockset. Retract key halfway from cylinder. Depress locking button and pull off knob with cylinder. Rotate cylinder 180° and slip knob back onto spindle.

STEP ONE

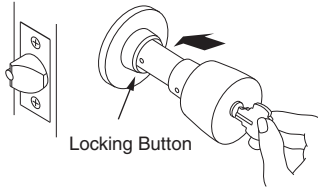

With key in cylinder, align hole in knob and cap and slip knob over spindle up to locking button.

STEP TWO

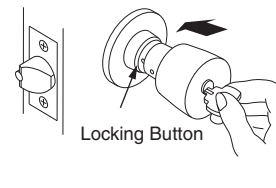

With knob or lever against locking button, depress locking button and push knob or lever until button engages hole. Test for proper operation.

TEMPLATE

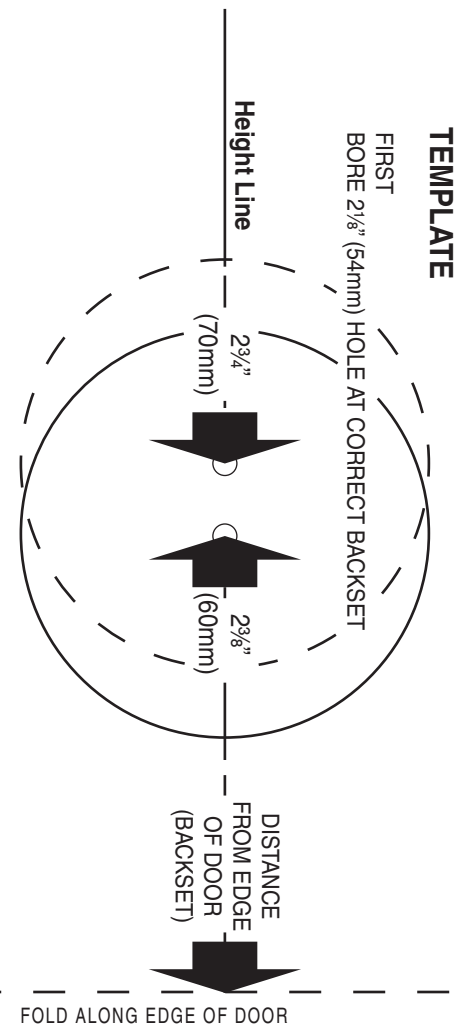

RECOMMENDED TEMPLATE INSTRUCTIONS MUST BE FOLLOWED TO ASSURE PROPER FUNCTION.

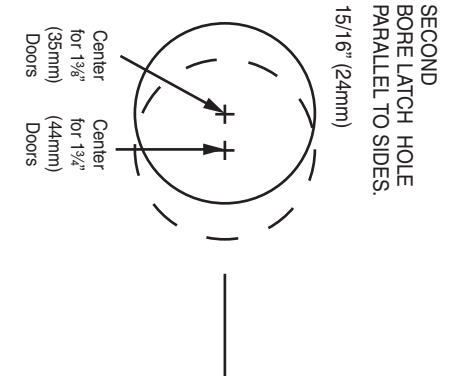

Remove template from instructions



© Allegion 2014
Printed in U.S.A.
030091-000-70 Rev. 10/14-d

FALCON®

8.500

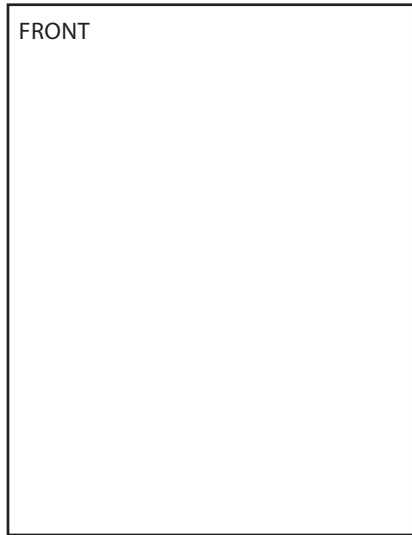

11.000

Additional Notes:
1. None

Revision History						Revision Description: D > Revised artwork					
A	B	C	D	E	F						
none	0790	6683									
Material						Edited By		Approved By		EC Number	Release Date
White Paper						J. Ellis		M. Roberts		xxxxx	10/14
Notes						Title					
1. printed one side						Falcon F Series Locks					
2. printed black						Creation Date		Number		Revision	
3. tolerance ± .13						10-22-14		030091-000-70		D	
4. printed in country may vary						Created By		Activity		© Allegion 2014	
						J. Ellis		3899 Hancock Expwy Security, CO 80911			
						Software: InDesign CS6					