

# INSTALLATION INSTRUCTIONS FOR FALCON® F SERIES LOCKS FOR INTERCHANGEABLE CORES

1

## MARK DOOR

Recommended template instructions must be followed to assure proper functioning. (See attached template). Mark height line on edge of door 38" from floor.

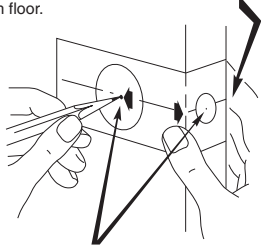

Using height line, mark centers for latch hole and side hole on both sides of door.

2

## BORE 3 HOLES

A. Bore side hole from both sides of door.

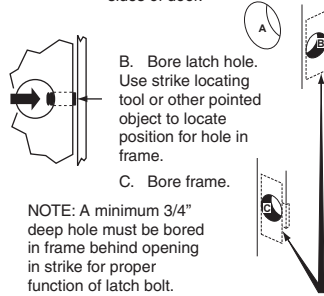

B. Bore latch hole. Use strike locating tool or other pointed object to locate position for hole in frame.

C. Bore frame.

NOTE: A minimum 3/4" deep hole must be bored in frame behind opening in strike for proper function of latch bolt.

Outline latch face and strike as illustrated and chisel out to proper depth.

3

## INSTALL LATCH AND STRIKE

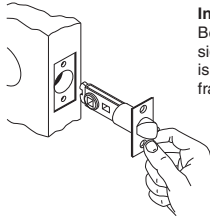

**Install latch.**  
Be sure beveled side of latch bolt is facing the door frame.

**Install strike.**  
If dust box is to be used, clear area with wood chisel.

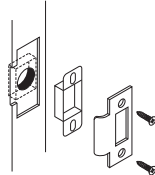

4

## REMOVE INSIDE TRIM

Depress locking button to remove knob or lever.\*

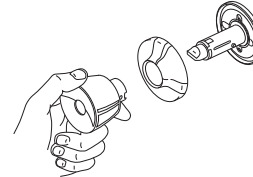

Pull knob or lever off of spindle. Unsnap rose from mounting plate. It will be necessary to pry the rose with a very thin flat screwdriver, nail or other thin object. Pry under or near the tiny depressions on the edge of the rose and remove from spindle.

\* If cylinder knob or lever, see below.

5

## INSTALL OUTSIDE KNOB OR LEVER

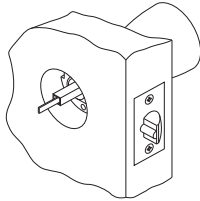

Insert outside trim thru center of latch. Hold flush against door.

Insert outside trim thru center of latch. Hold flush against door.

6

## INSTALL INSIDE ASSEMBLY

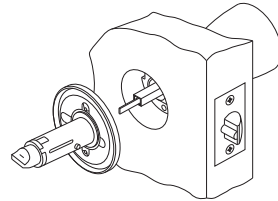

Slide inside assembly over locking bar; insert and evenly tighten machine screws.

Note: Locking button in lever locks **must** be positioned towards the edge of the door.

7

## INSTALL ROSE AND KNOB OR LEVER

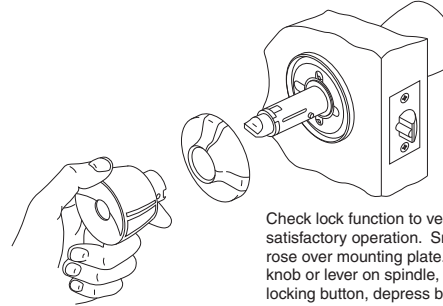

Check lock function to verify satisfactory operation. Snap rose over mounting plate. Place knob or lever on spindle, slide to locking button, depress button and push knob or lever until button engages hole.

## INSTRUCTIONS FOR REMOVING OUTER KNOBS OR LEVERS

### A TO REMOVE INTERCHANGEABLE CORE KNOB

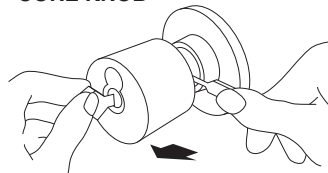

Unlock outer knob or lever with key. Remove core. Depress locking button and pull off knob or lever.

### B TO INSTALL INTERCHANGEABLE CORE KNOB

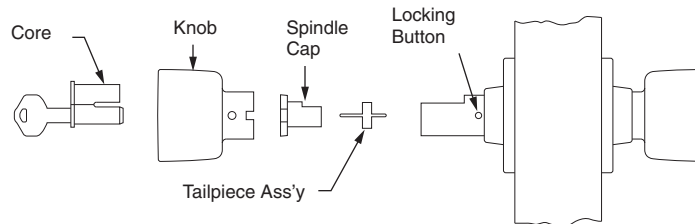

Slide tailpiece assembly into spindle, engaging single leg with drive cam in spindle.

Insert spindle cap into end of spindle, notch up. Slide knob over spindle to locking button, push in locking button and push knob until locking button engages hole in knob. Install core.

RECOMMENDED TEMPLATE INSTRUCTIONS MUST BE FOLLOWED TO ASSURE PROPER FUNCTION.

TEMPLATE

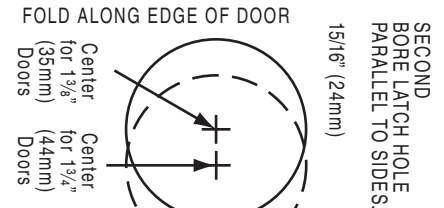
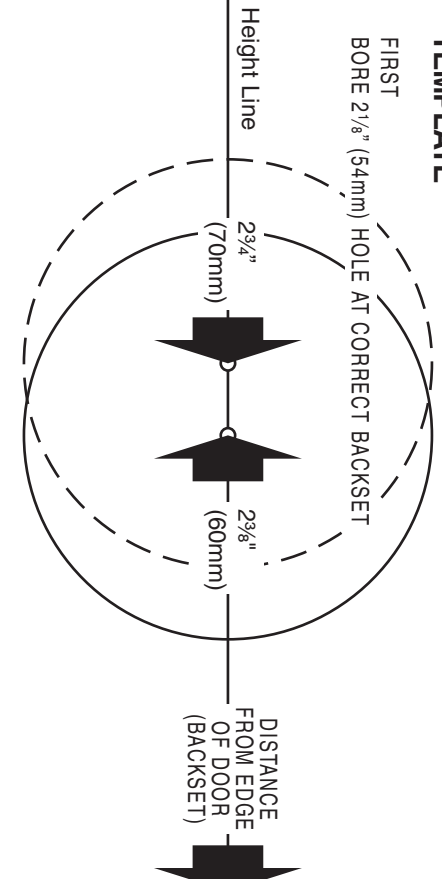

Remove template from instructions

# FALCON®

030092-000-70



ALLEGION™

© Allegion 2014  
Printed in U.S.A.  
030092-000-70 Rev. 10/14-d

8.500

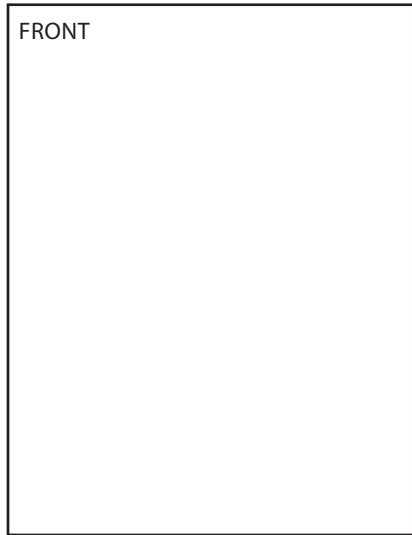

11.000

Additional Notes:
1. None

Revision History						Revision Description: D > Revised artwork					
A	B	C	D	E	F						
none	0790	6683									
Material						Edited By		Approved By		EC Number	Release Date
White Paper						J. Ellis		M. Roberts		xxxxx	10/14
Notes						Title					
1. printed one side						Falcon F Series Locks for Interchangeable Cores					
2. printed black						Creation Date		Number		Revision	
3. tolerance ± .13						10-22-14		030092-000-70		D	
4. printed in country may vary						Created By		Activity			
						J. Ellis		3899 Hancock Expwy Security, CO 80911			
						Software: InDesign CS6				© Allegion 2014	