



24743437

Trim  
Moldura  
Garniture

R/V

**LSDA**

Installation Instructions  
Instrucciones de instalación  
Notice d'installation

**1** Transfer  $\mathcal{C}$  from device side to trim side of door  
Transfiera  $\mathcal{C}$  desde el lado del mecanismo al lado de la moldura de la puerta  
Transfert  $\mathcal{C}$  du côté du dispositif vers la garniture latérale de porte

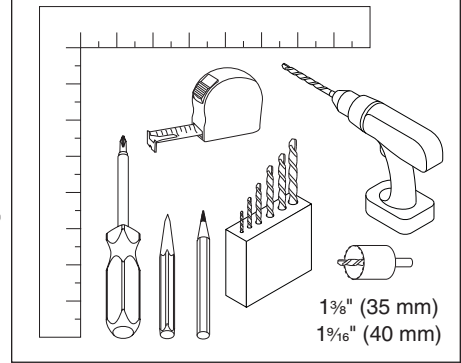
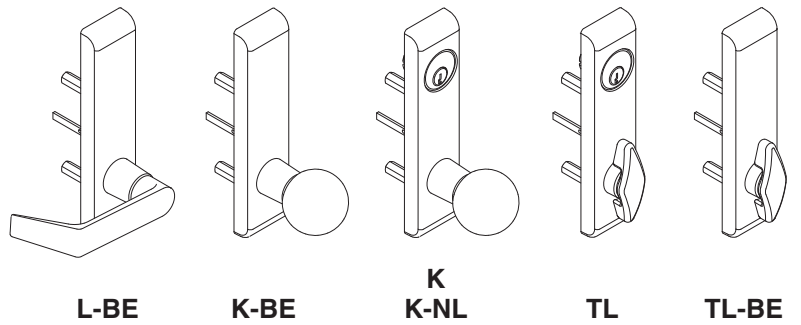
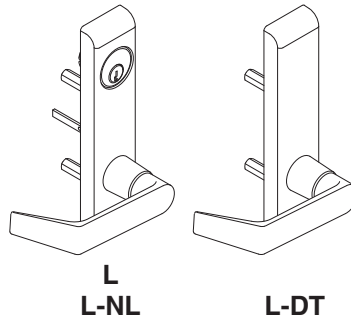
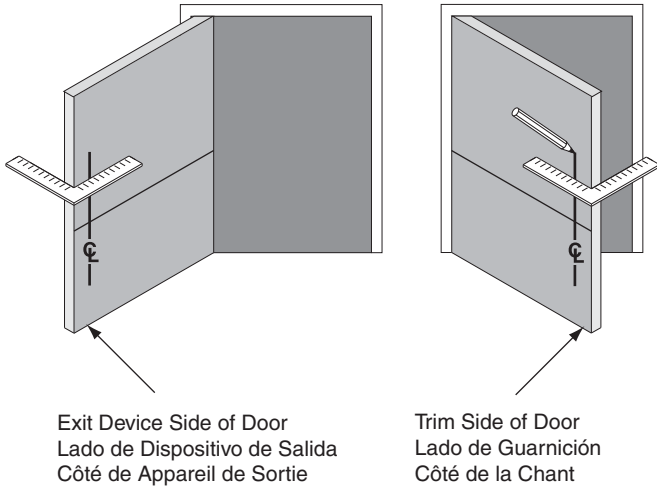

1 3/8" (35 mm)  
1 1/16" (40 mm)

**2** Prepare Door  
Prepara la Puerta  
Préparer la Porte

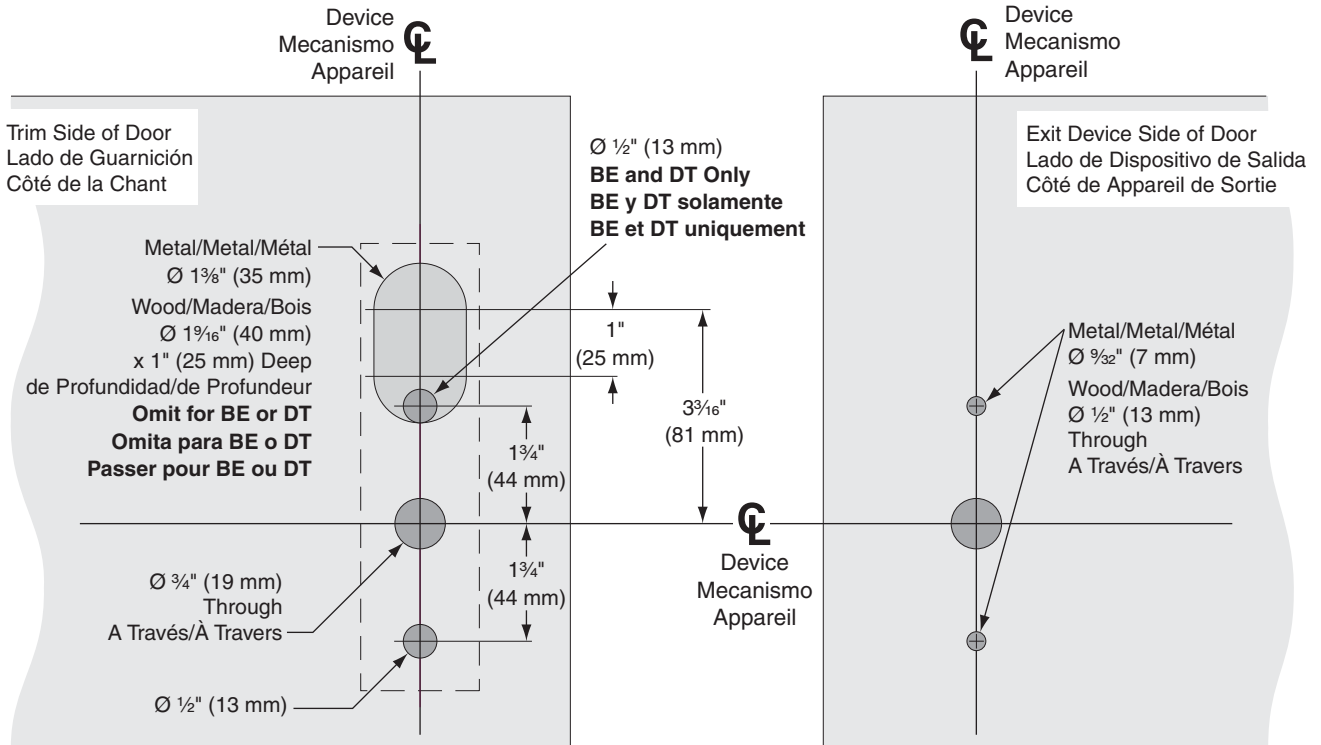

**3** Assemble Tailpiece  
Arme la cola del pestillo  
Assembler la pièce de raccordement

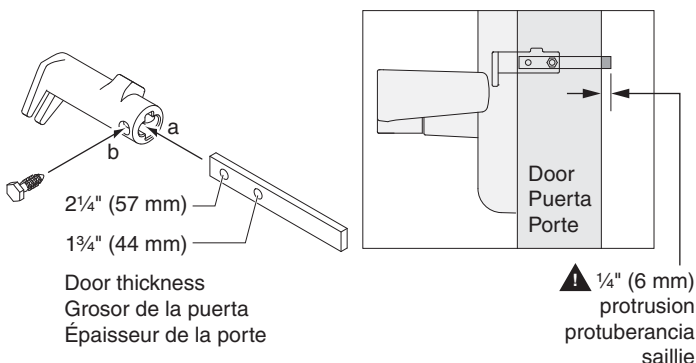

**4** Install Tailpiece Guide into Exit Device Cam  
Instale la guía de la cola del pestillo en la cámara del dispositivo de salida  
Installer le guide de la pièce de raccordement dans la caméra de l'appareil de sortie

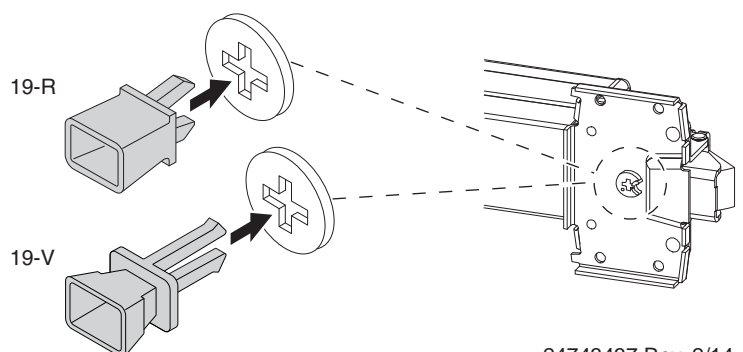

24743437 Rev. 2/14\_a

5

If Necessary, Rehand Trim

De ser necesario, ajuste la moldura

Réutiliser la garniture si nécessaire

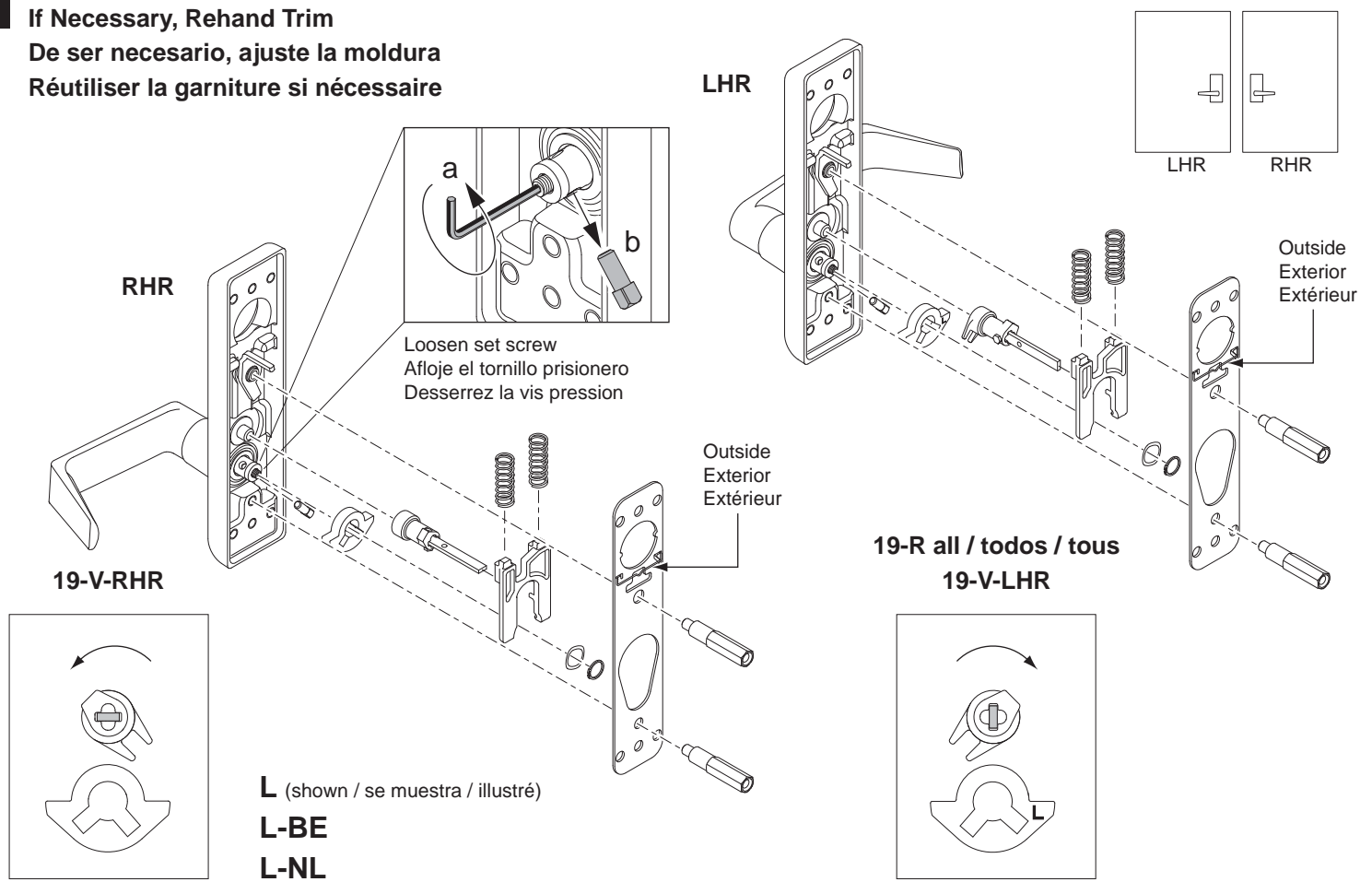

**K** (shown / se muestra / illustré)

**K-BE**

**K-NL**

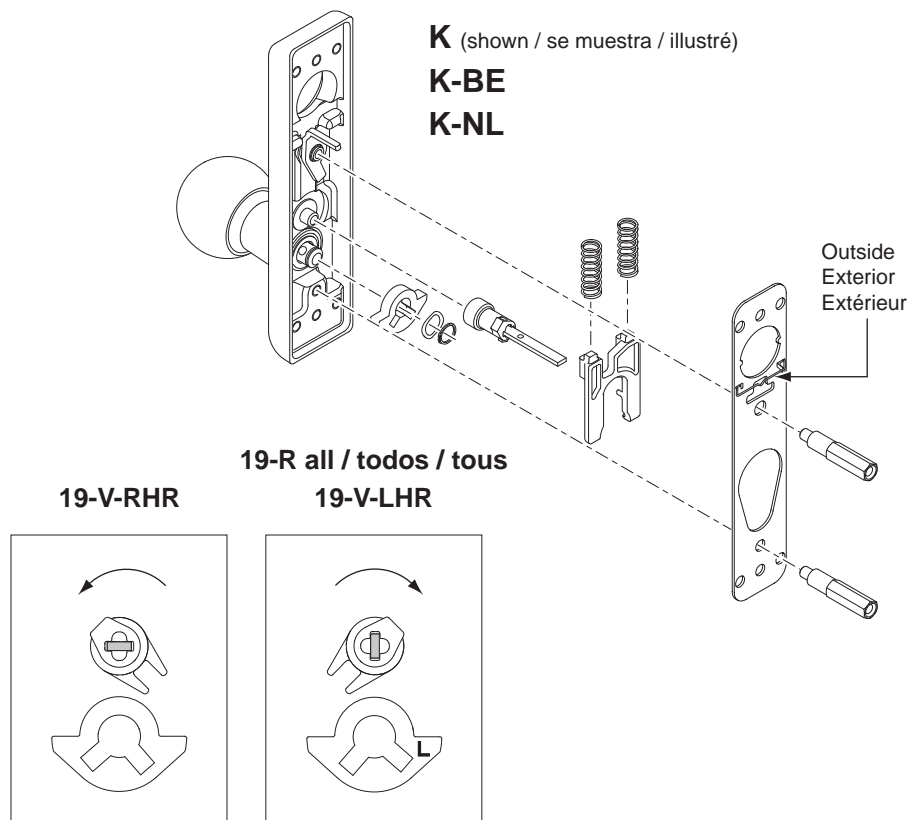

**L-DT**

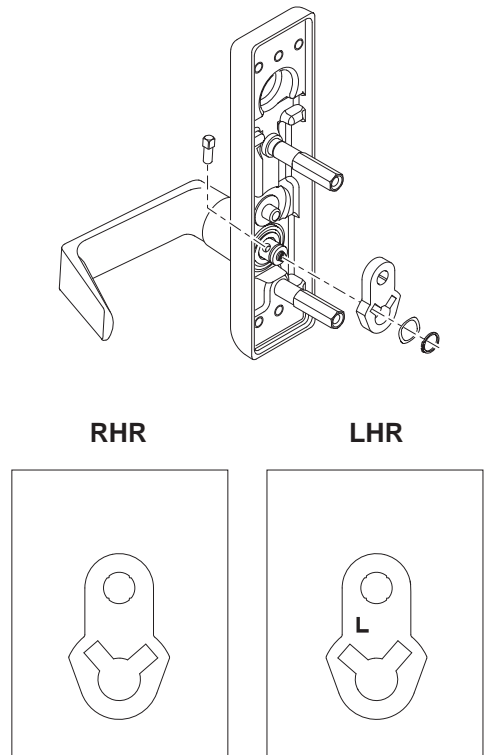

6

If Necessary, Install Cylinder

De ser necesario, instale el cilindro

Installer le cylindre si nécessaire

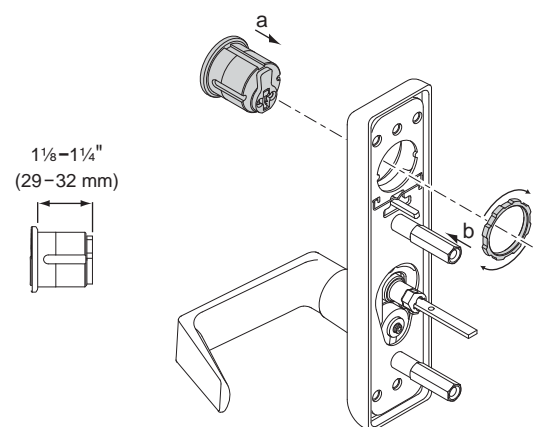

7

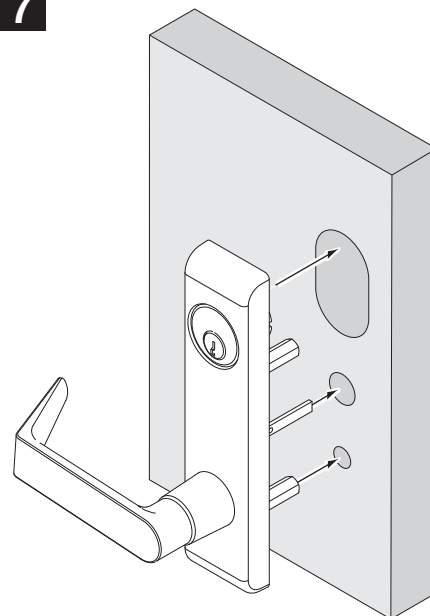

Return to  
Device Instructions  
Regrese a Instrucciones  
del mecanismo

Retour vers les instructions  
du dispositif