

VON DUPRIN®

Installation Instructions

6000 Series Electric Strike Refurbish Kit

PARTSLIST



6-32 X 1/4" Socket head cap screw (10)

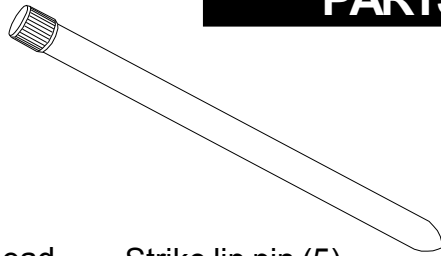

Strike lip pin (5)

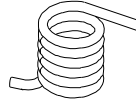

Torsion spring (5)



Tripper spring (5)

INSTALLATION



NOTES

- Turn off power to strike before removal.
- Do not reuse the strike lip pin.

Tools required:

- Phillips screwdriver
- 5/64" hex wrench
- Flat punch (.100" - .175")
- Hammer
- Vice or heavy duty work bench

1

Remove strike and strike box.

See Figure 1-1

- 1.1. Remove strike mounting screws and remove strike assembly from frame.
- 1.2. Unplug solenoid.
- 1.3. Remove strike box screws using phillips screwdriver and remove strike box from faceplate.

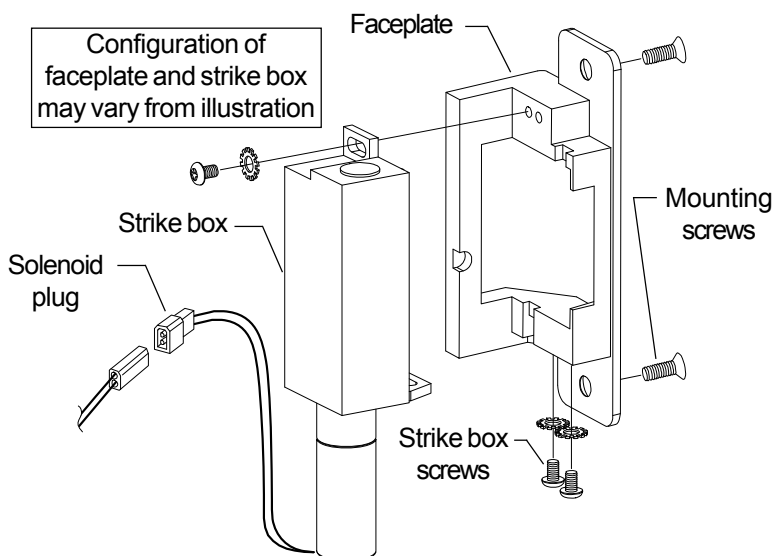

Figure 1-1

2

Remove strike box cover and plug.

See Figure 2-1.

- 2.1. Using 5/64" hex wrench, remove two socket head screws and remove strike box cover.
- 2.2. Remove black hole plug if present.

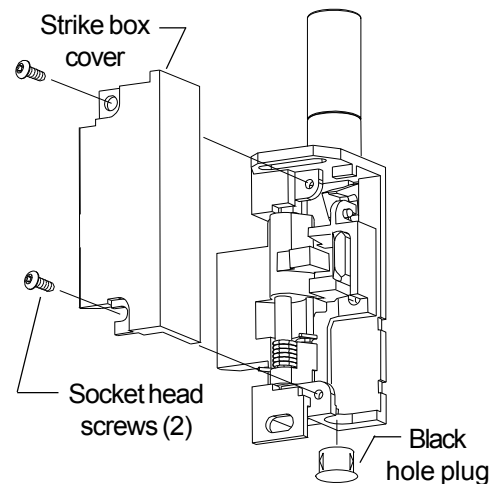

Figure 2-1

Customer Service
1-877-671-7011 www.allegion.com/us



ALLEGION

© Allegion 2015
Printed in U.S.A.
931020_00 Rev. 06/15-b

3 Remove strike lip pin, spring(s), and switch (if present).

See Figure 3-1.

- 3.1. Slide switch off box (if present).
- 3.2. Observe the strike lip pin currently in strike box and find rounded end.
- 3.3. Place strike box on vice or heavy duty work bench as shown with rounded end of pin up.
- 3.4. Using a flat punch (.100" to .175" diameter) hammer pin out of strike box.
- 3.5. Remove torsion spring and tripper spring (if present).

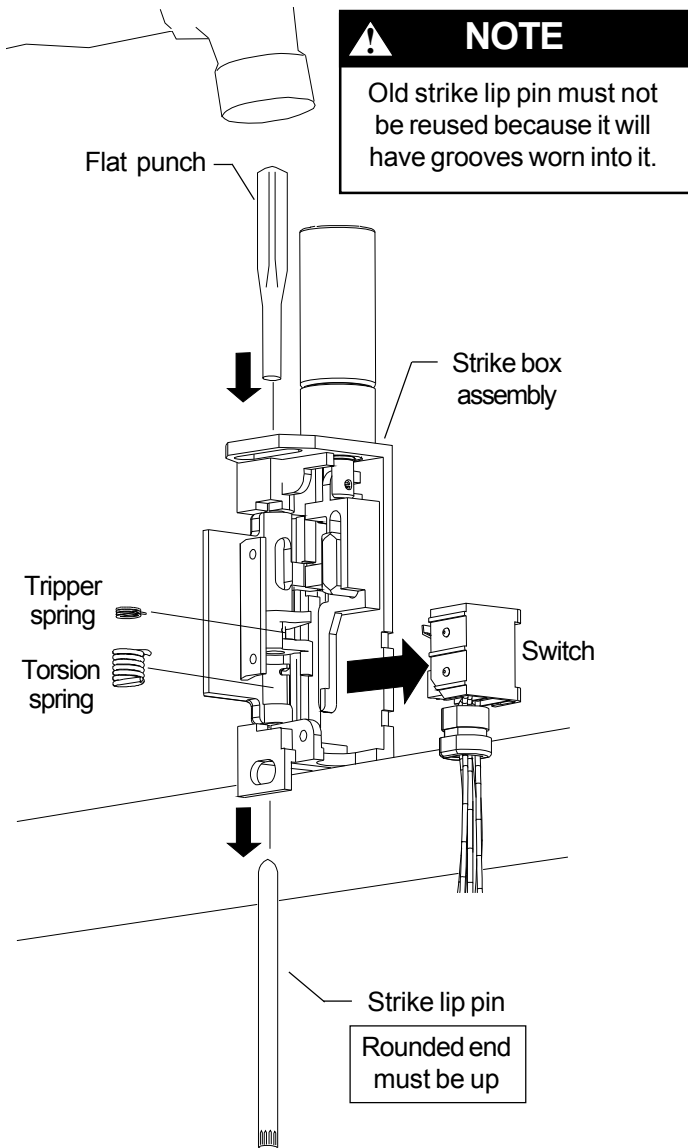

Figure 3-1

4 Install new torsion spring and new pin.

See Figure 4-1.

- 4.1. Flip strike box over and align strike lip.
- 4.2. Align new spring in strike lip groove as shown.
- 4.3. Slide new strike lip pin into strike box in same direction of old pin with rounded end down.

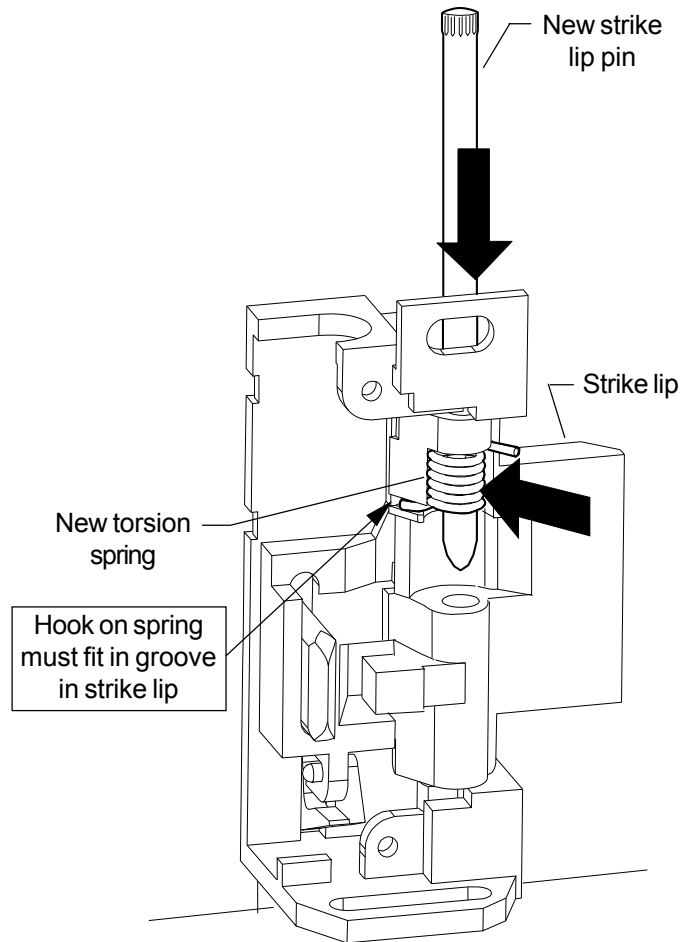

Figure 4-1

5 Install tripper spring (for DS strikes only).

See Figure 5-1.

- 5.1. Align hooked end of new spring in tripper groove as shown.
- 5.2. Slide new strike lip pin through strike lip and tripper.

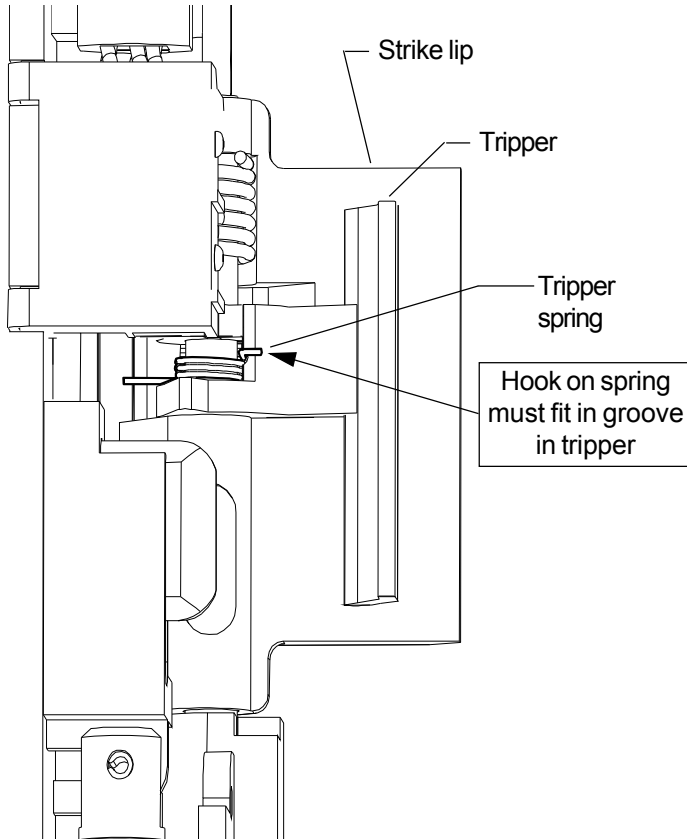

Figure 5-1

6 Secure new pin.

See Figure 6-1.

- 6.1. Using flat punch and hammer, drive pin until flush with strike box surface.
- 6.2. Verify pin is secure by pressing flat punch against rounded end of pin by hand.
If pin moves, remove and repeat steps 4-6 installing pin from opposite end of box.

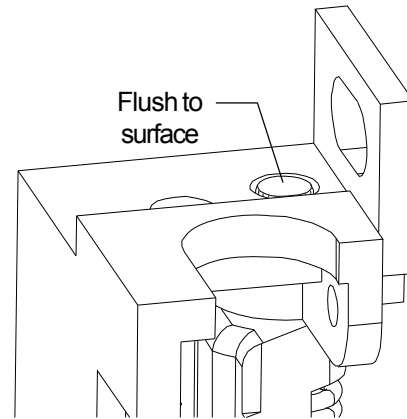

Figure 6-1

7 Reinstall switch (if present).

See Figure 7-1.

- 7.1. Rotate strike lip and tripper to closed position as shown (slider may need to slide down temporarily).
- 7.2. Slide switch back onto box.
- 7.3. Verify switch actuator is in correct position and keep strike lip in closed position .

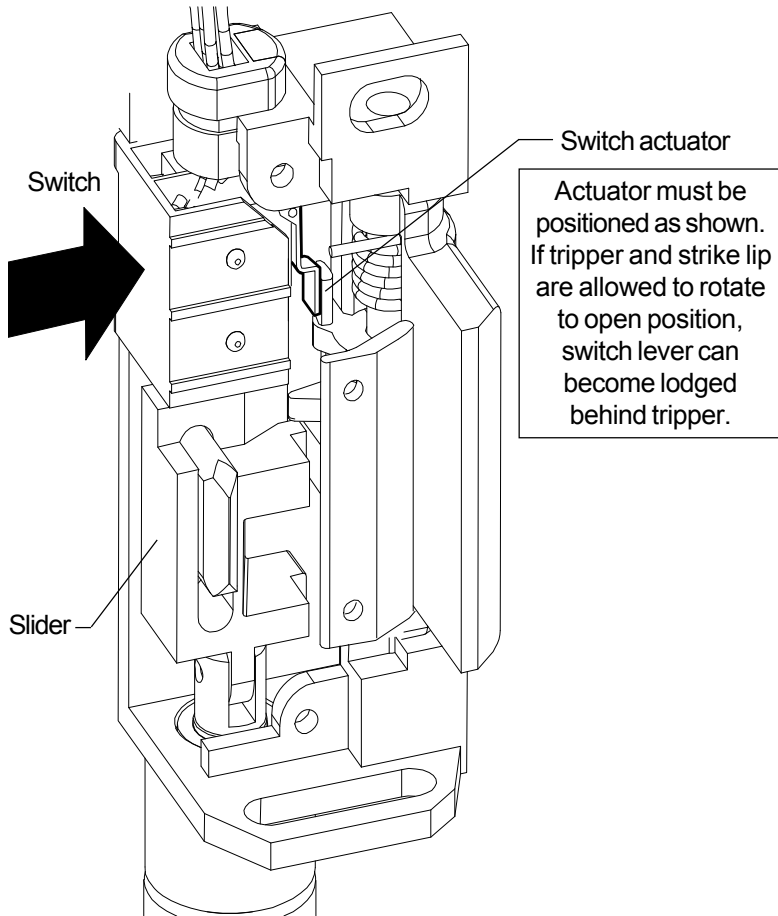

Figure 7-1

8 Reassemble strike.

See Figure 8-1.

- 8.1. Place strike box cover onto box (ensure spring tip is inside box cover).
- 8.2. Secure strike box cover with two socket head screws using 5/64" hex wrench.
- 8.3. Replace black hole plug if present.
Rotate strike lip by hand and verify that it opens and returns fully without binding (Fail secure strikes must be energized).
- 8.4. Reinstall box into faceplate.
- 8.5. Plug in solenoid.
- 8.6. Reinstall strike into door frame and secure with mounting screws.
Refer to strike installation instructions if necessary during reinstallation.

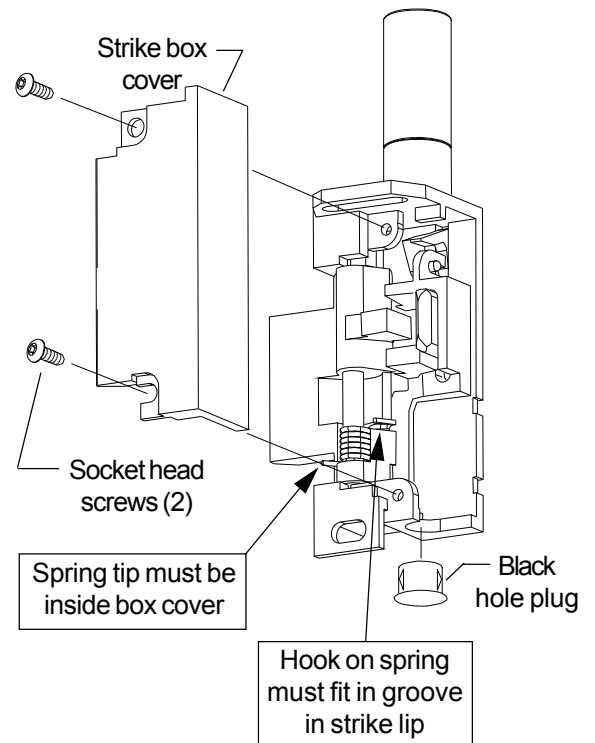

Figure 8-1