

## DOOR & FRAME PREP

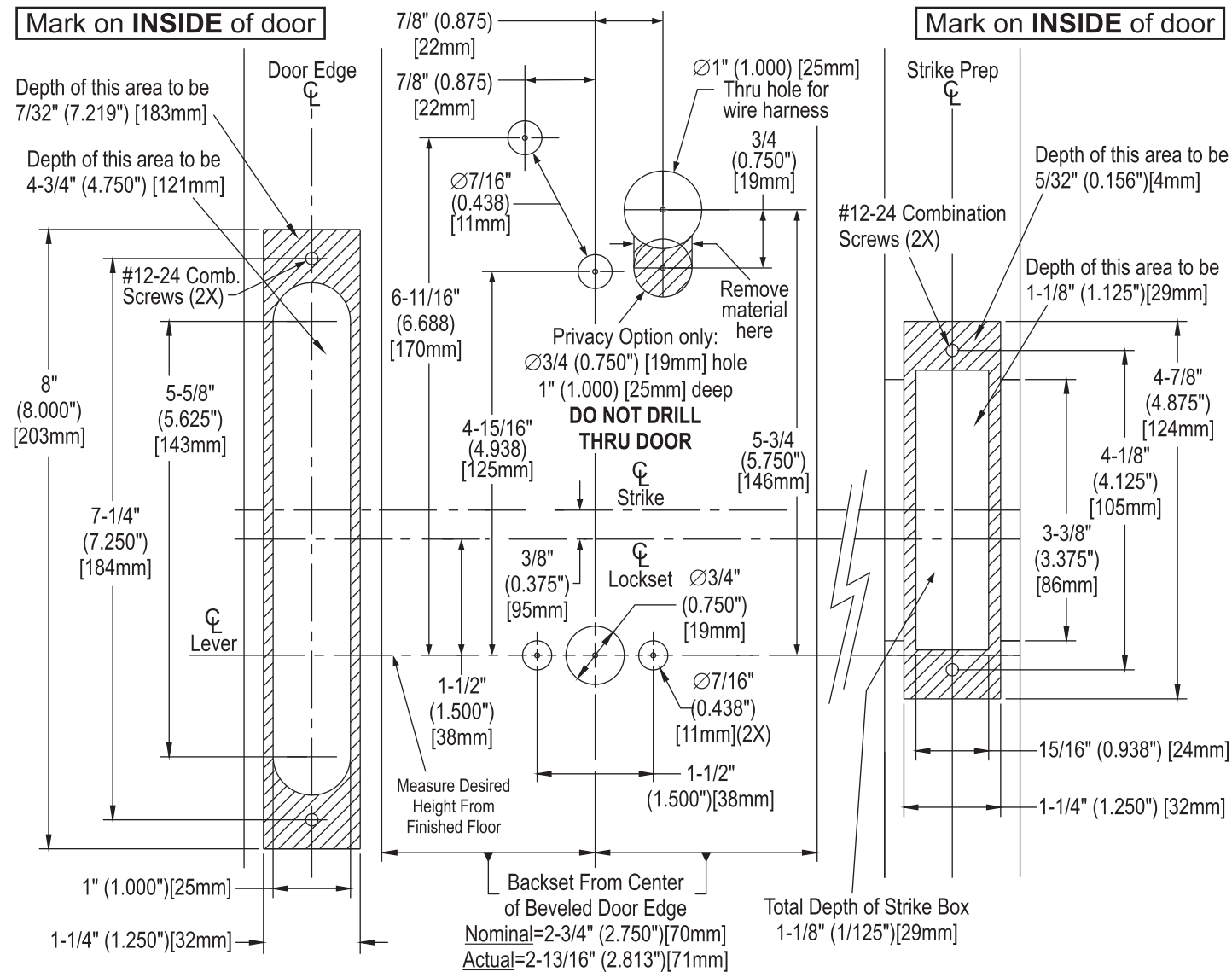

## COMPUTER MANAGED & CAMPUS LOCK SYSTEMS (Mortise) CM5500 & CL5500 SERIES

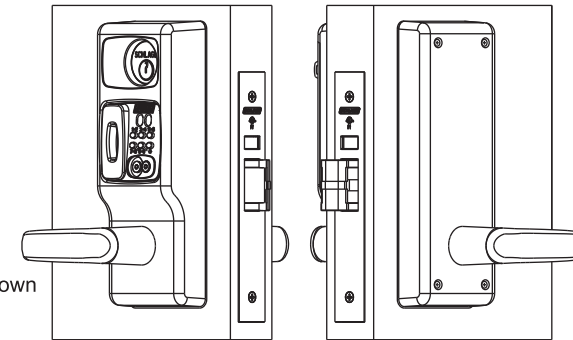

Lock is shown with PXX credential.

Customer Service  
1-877-671-7011 www.allegion.com/us



© Allegion 2015  
Printed in U.S.A.  
55005 Rev. 05/15-p

## INSTALLATION INSTRUCTIONS

### INTRODUCTION

This manual covers the complete hardware installation of all models in the CM5500 and CL5500 Series line of mortise locks.

### NOTES:

- Illustration on pages 2 and 3 shows a LHR installation, but yours might be different.
- Key cylinder to be 1-1/8" [29mm] or longer with Schlage B502-191 or Schlage B502-948 or equivalent cam.
- For manual programming instructions and information on using access cards and electronic keys, see the programming guide.
- For computer programming instructions, see the documentation and help files included with the computer software.
- During installation, use care not to drop any hardware behind PCB on inside escutcheon.
- Do not overtighten fasteners.

### OPERATIONAL TEST - CM5500 SERIES LOCKS:

- Push down on inside lever. Latch should retract.
- Push down and up on outside lever. Lever should be disengaged and door should not unlock.
- Insert key, turn CW to stop (about 1/2 turn).
- Push down on outside lever. Latch should retract. Units w/ATK option, green LED should flash.
- Units w/keypad - enter factory default access code: **13579**. A quiet "whir", green LED flashes (approx. 10 sec).
- With green LED flashing, push handle down. Latch should retract. When green LED stops flashing, a quiet "whir", lock relocks.
- Test handle. It should be locked.

### OPERATIONAL TEST - CL5500 SERIES LOCKS:

- Push down on inside lever. Latch should retract.
- Push down on outside lever. Lever should be disengaged and door should not unlock.
- Insert key, turn CW to stop (about 1/2 turn).
- Push down on outside lever. Latch should retract. Units w/ATK option - green LED should flash when key is turned.

### NON-SUPPLIED TOOLS & MATERIALS NEEDED

- Philips head screwdriver set
- Power Drill w/3/8" [10mm] chuck
- Drill bit set (up to 1" [25mm])
- 1-1/4" [32mm] Hole saw w/mandrel
- Allen wrench set
- Square (90 degrees)
- Loctite 242 (or equivalent)
- Tape Measure
- Pencil
- Center Punch
- Hammer
- Chisel
- Level
- Masking tape

See Back Cover for:  
- Door & Frame Preparation  
- Mortise Case Handing

### BLOCKING RING TABLE

Key Cylinder Length	Blocking Ring (Schlage P/N: XXX=finish)
1-1/4" [32mm]	1/8" [3mm] (36-079-012-XXX)
1-3/8" [35mm]	1/4" [6mm] (36-079-025-XXX)
1-1/2" [38mm]	3/8" [10mm] (36-079-037-XXX)
1-5/8" [41mm]	1/2" [13mm] (36-079-050-XXX)

This device complies with part 15 of FCC rules. Operation is subject to following two conditions:  
(1) This device may not cause harmful interference.  
(2) This device must accept any interference received, including any interference that may cause undesired operation. Changes or modifications not expressly approved by party responsible for compliance could void user's authority to operate equipment.

## MORTISE CASE HANDING

Verify, and if necessary, reconfigure mortise case handing.

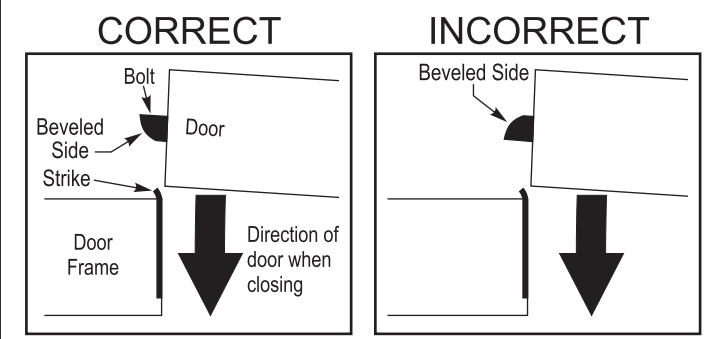

Perform steps 1 thru 6 if mortise case is handed incorrectly.

- Extend bolt fully by pressing on deadlatch. Insert change key into slot to fix latch shaft in position.
- Use 5/64" [2mm] hex wrench to loosen latch bolt set screw.
- Keep spring in place as you pull latch off shaft and reverse position.
- Apply thread lock compound to set screw. (Loctite 242 recommended)
- Push bolt firmly back onto shaft. Tighten latch set screw.
- Remove change key from slot.

After door & frame have been prepared, refer to illustration below and install strike components into door frame in following order :

- 1 - Insert **A**.
- 2 - Place **B** against **A**.
- 3 - Secure **A** and **B** with **C**.

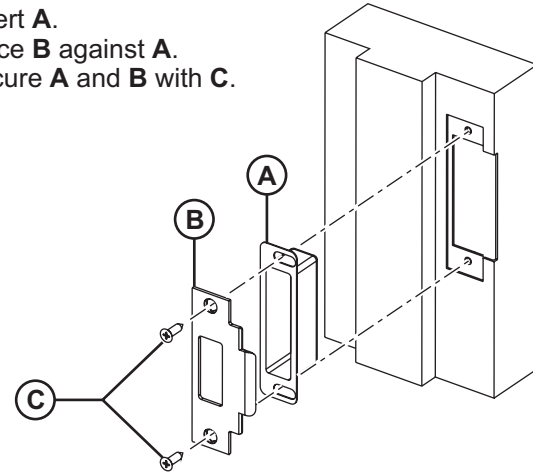

After strike components have been installed, refer to illustration on right and assemble lock components onto door in following order :

- 1 - Insert **D** (Autobolt or Latchbolt).  
**Locks with Privacy or Apartment function only:**  
 > Feed **E** thru door edge hole & out **wire hole** (inside door).
  - 2 - Loosely secure **D** with **F**. (DO NOT FULLY TIGHTEN **F**)
  - 3 - Install Key Cylinder:  
 > If **G** is longer than 1-1/8" [29mm], slide **H** over **G** (refer to **BLOCKING RING TABLE** on page 1).  
 > Insert **G**.  
 > Slide **I** over **G**.  
 > Using **K**, screw **J** onto **G** until tight.  
 > Line up nearest notch on **J** with tab on **I**.  
 > Bend tab on **I** into notch of **J**.
  - 4 - If changing the Handing, (refer to **DETAIL D-A**):  
 > Remove: **K**, (use 5/32"[4mm] hex wrench).  
 > Remove **L** from shaft.  
 > Rotate **L** 180 degrees, slide back onto shaft.  
 > Apply threadlocker to **K** and reinstall.  
 > Inside escutcheon - repeat with **K** and **L** as above.
  - 5 - Verify that key cylinder is functional.
  - 6 - Mount Outside Escutcheon (**N**):  
 > Apply sticky side of **M** to **N** (feed **O** thru hole in **M**).  
 > Install **P** and **Q**.  
 > Verify **R** is at bottom, insert round end of **S** into **T**.  
 > Feed **O** thru **wire hole** in door.  
 > Press **N** to outside of door.  
 > Press **U** to inside of door, secure with **V** and **W**.
  - 7 - Plug **O** into **X**. Route wire under clip.
  - 8 - Observing polarity, install 4, AA batteries into **Y**.
  - 9 - Slide **Z** over nipple end of **Aa**.
  - 10 - Insert square end of **Aa** into **Ba**.
  - 11 - If needed, use shims to center **D** in pocket.
  - 12 - Fully tighten **F**.
  - 13 - Place **Ca**, secure with **Da**.
- Skip to step 16 if lock does not have **Apartment** or **Privacy**.

CONTINUED ON PAGE 3...

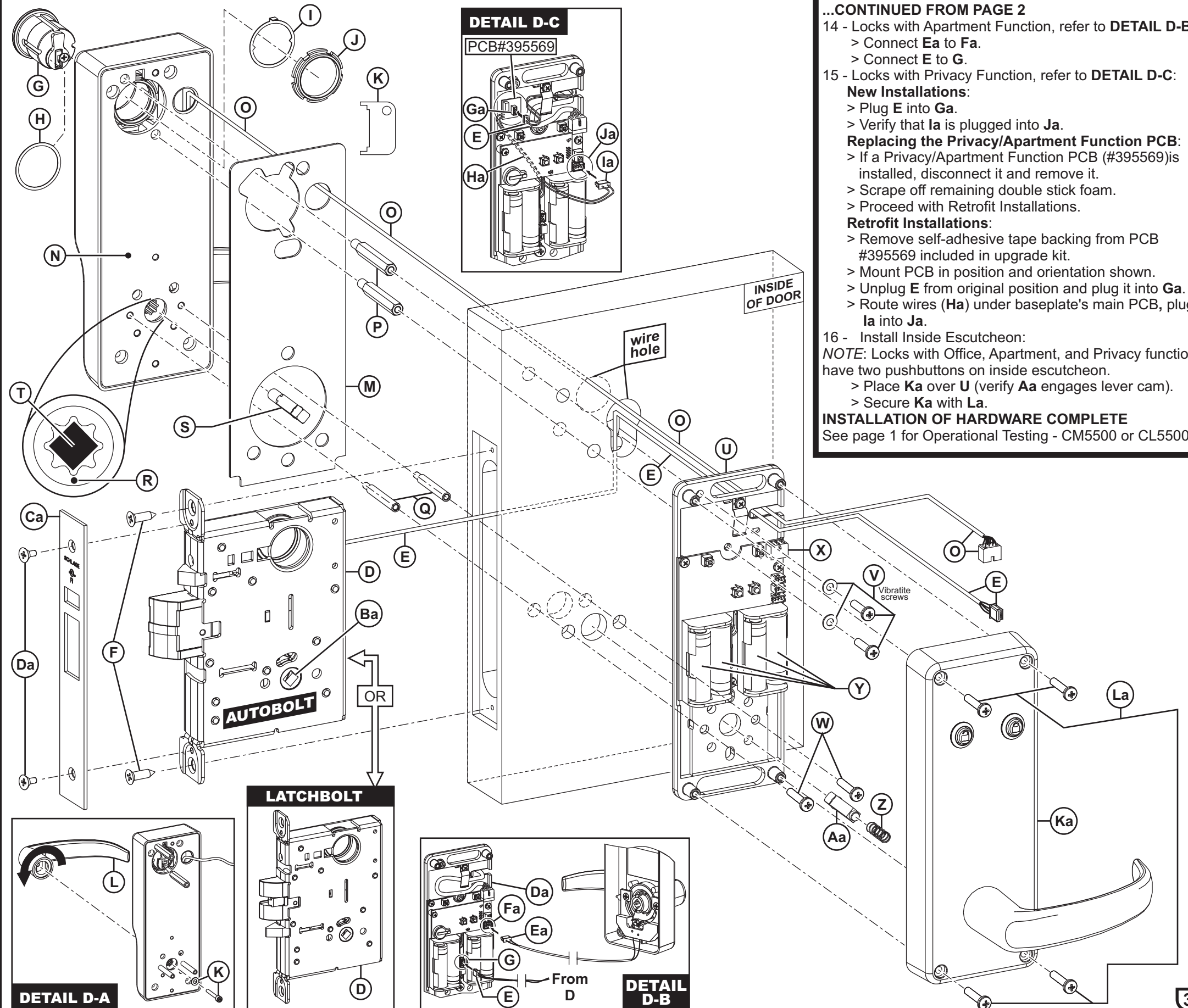

...CONTINUED FROM PAGE 2

- 14 - Locks with Apartment Function, refer to **DETAIL D-B**:  
 > Connect **Ea** to **Fa**.  
 > Connect **E** to **G**.
  - 15 - Locks with Privacy Function, refer to **DETAIL D-C**:  
**New Installations:**  
 > Plug **E** into **Ga**.  
 > Verify that **Ia** is plugged into **Ja**.  
**Replacing the Privacy/Apartment Function PCB:**  
 > If a Privacy/Apartment Function PCB (#395569) is installed, disconnect it and remove it.  
 > Scrape off remaining double stick foam.  
 > Proceed with Retrofit Installations.  
**Retrofit Installations:**  
 > Remove self-adhesive tape backing from PCB #395569 included in upgrade kit.  
 > Mount PCB in position and orientation shown.  
 > Unplug **E** from original position and plug it into **Ga**.  
 > Route wires (**Ha**) under baseplate's main PCB, plug **Ia** into **Ja**.
  - 16 - Install Inside Escutcheon:  
**NOTE:** Locks with Office, Apartment, and Privacy function have two pushbuttons on inside escutcheon.  
 > Place **Ka** over **U** (verify **Aa** engages lever cam).  
 > Secure **Ka** with **La**.
- INSTALLATION OF HARDWARE COMPLETE**  
 See page 1 for Operational Testing - CM5500 or CL5500