



47640278

-2 and -2 SI

VON DUPRIN®

Device and Retrofit Installation

FOR NEW DEVICE INSTALLATION, BEGIN HERE.

FOR RETROFIT INSTALLATION, GO TO PAGE 3.



WARNING

Double cylinder options (-2/-2SI) are ideal for fire exit hardware and panic hardware that are not equipped with the dogging feature. Combining a double cylinder option with the dogging feature is not recommended, as the hardware could be in the dogged (unlatched) position when the indicator states a locked position.

User manual to be transferred to owner after product installation.

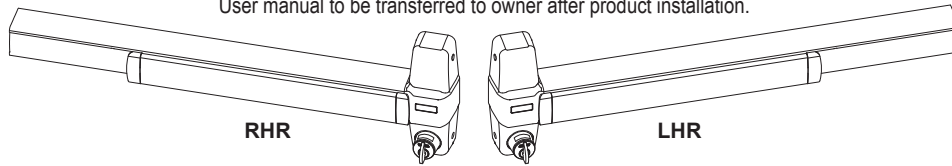

Module Types

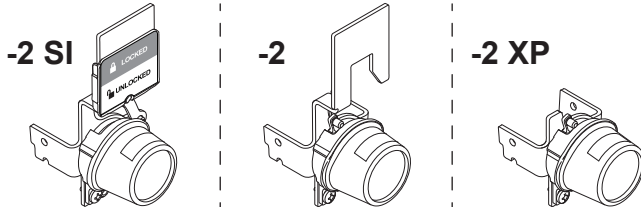

Additional Parts Included

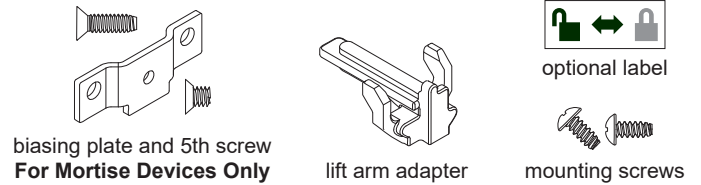

1 For Mortise Devices Only, Install Biasing Plate to Center Case and Secure with Screw.

- Position biasing plate to back of center case on the bottom as shown.
- Secure biasing plate with screw through front of center case.

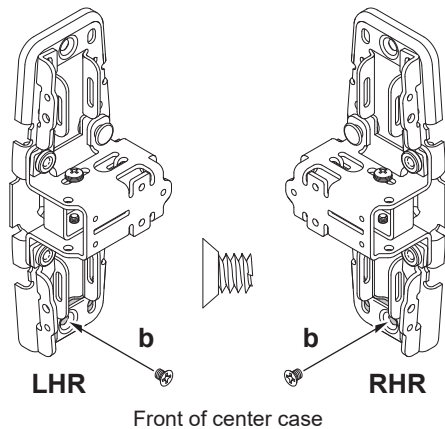
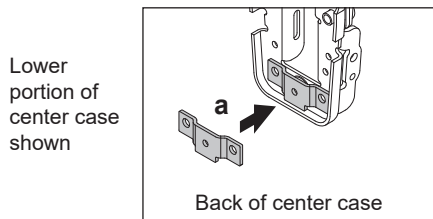

2 Install Device and Trim per Standard Instruction.

With the NL drive screw installed, key retracts latch bolt.

DO NOT remove NL drive screw.

The trim lock tumbler on the back of the device must be in the **UP** (unlocked) position before device is installed. This allows the trim to retract the latch when the push side cylinder is unlocked.

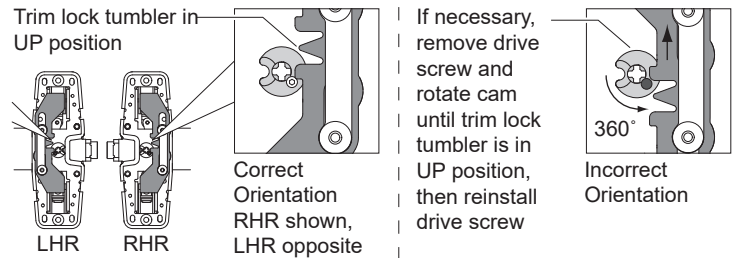

3 For Mortise Devices Only, Install 5th Self-Tapping Screw.

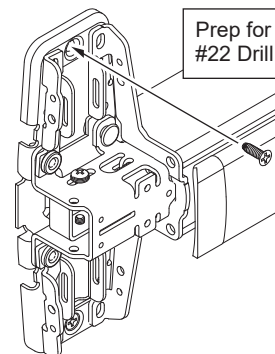

Prep for 5th screw
#22 Drill (.157")

With device and trim installed on door, drill hole and install 5th screw as shown.

4 Before Proceeding, Ensure Device is Installed on the Door and Functioning Appropriately.

5 Install Lift Arm Adapter.

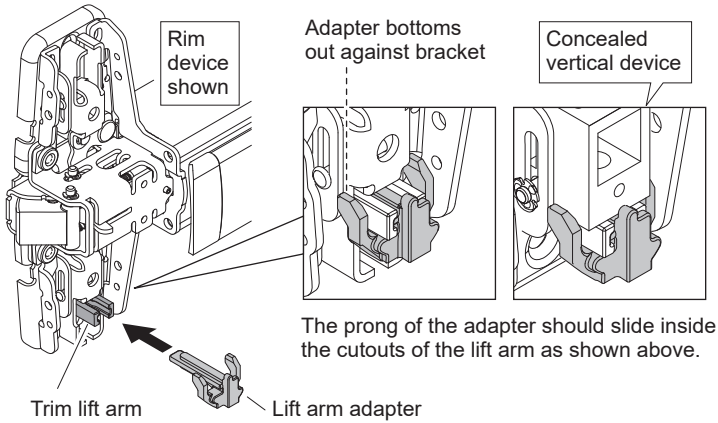

① For vertical and three-point device installations, double check the latches and adjust as required.

6 Confirm Cylinder Tailpiece is in Vertical Position, Rotate if Necessary.

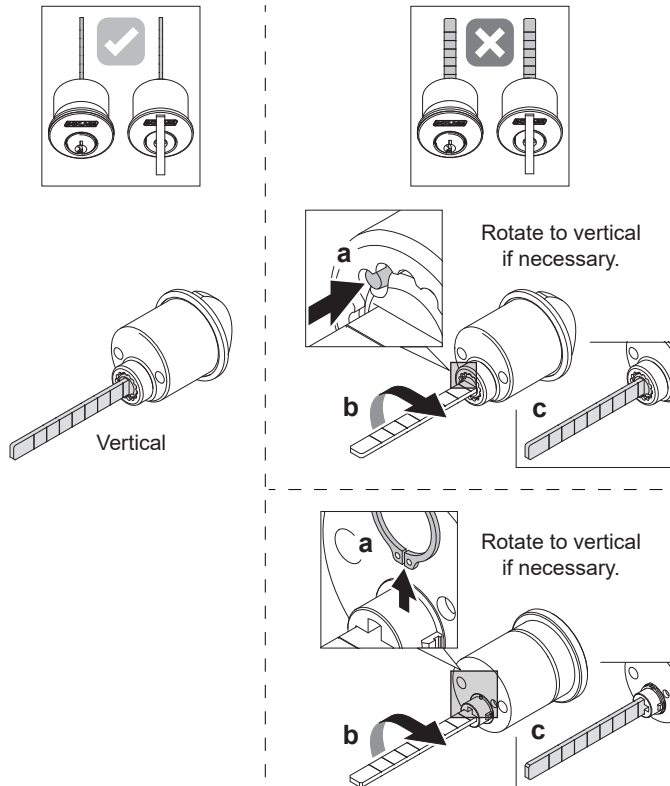

- a. Depending on the cylinder used, a push pin, retaining ring, or screws are used on the backside to orient the tailpiece. Some disassembly may be required to rotate the tailpiece including removal of screws or retaining ring.
- b. Rotate the tailpiece to vertical orientation. The keyway or thumb piece should not rotate when done correctly.
- c. If cylinder tailpiece cannot convert to vertical orientation, adapter kit 47686979 must be used.

7 Cut Tailpiece.

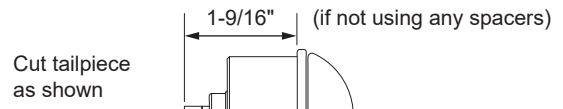

① Some cylinders may require additional spacers. Ensure proper fitment before cutting.

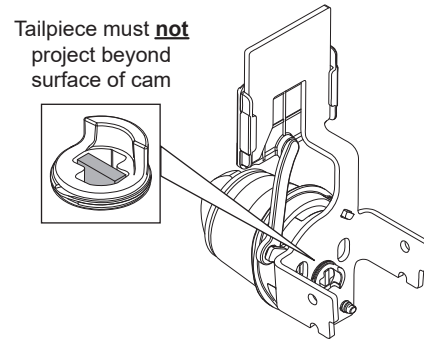

8 Install Cylinder.

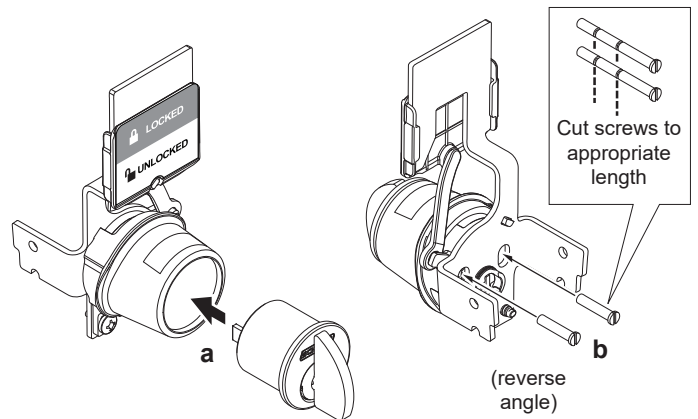

① Install cylinder in vertical (neutral home) position as shown. If using key cylinder, key should not be in cylinder during install.

Schlage Rim cylinder	20-021
Standard thumbturn cylinder	XB11-979
ADA thumbturn cylinder	XB13-379

9 Install Module.

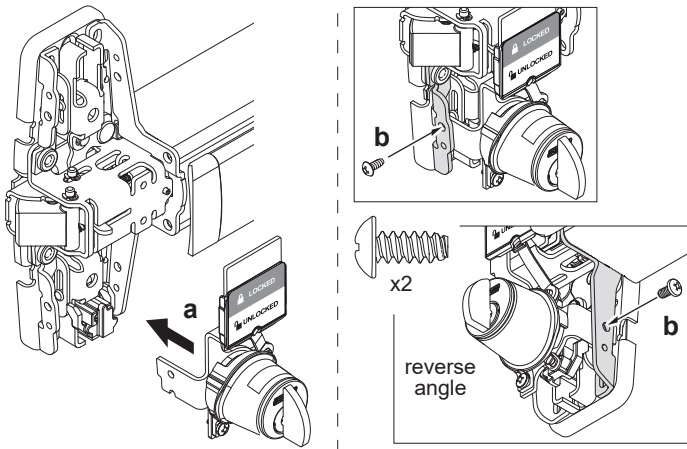

- ① Start each screw before fully tightening.
- ① Module can rotate until cover screws are installed in Step 10.

10 Install Cover.

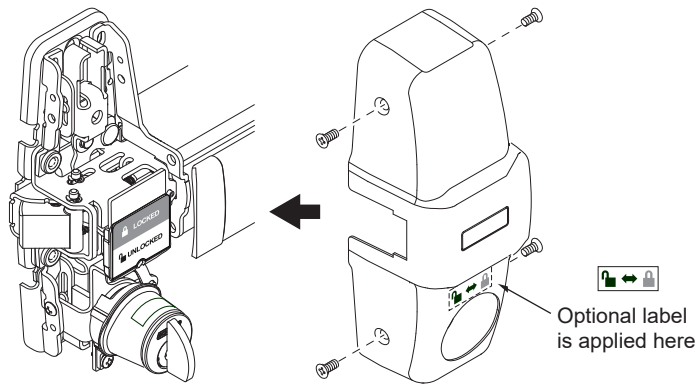

- ① For ADA thumbturn, install cover as follows

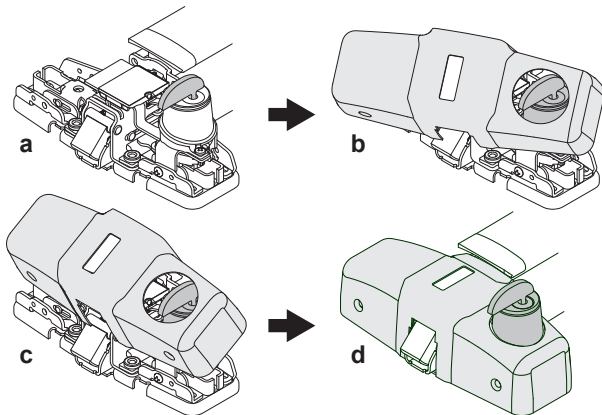

- a. Point ADA thumbturn towards latch side of device.
- b. Slip cover beneath long end of thumbturn.
- c. Rotate cover around thumbturn.
- d. Slip cover beneath push pad and into place.

11 Checklist

- Confirm outside trim locks and unlocks appropriately.
- Confirm free egress.
- Confirm full latchbolt retraction (if vertical rod device).

RETROFIT INSTALLATION

- 1 Remove Device and Trim from Door.

- 2 Remove Old Slider Assembly and Endplate.

- a. Remove cylinder (if applicable). Using a 5/16" nut driver, remove the two mounting studs nearest the lever and loosen the top two mounting studs between 1/8 and 1/4 of an inch.
- b. Tilt slider assembly up at an angle and remove endplate and slider assembly. Discard slider assembly and endplate.

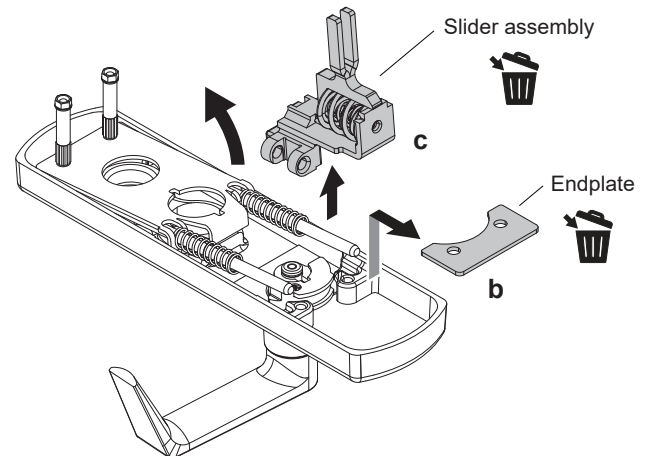
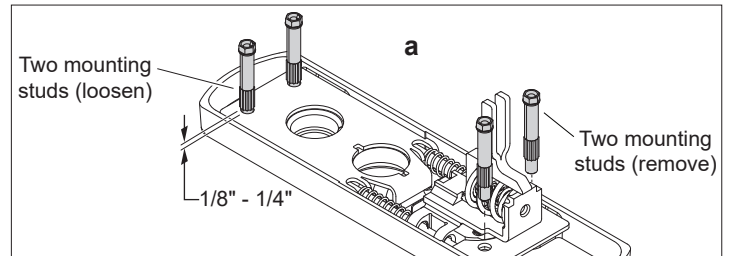

- 3 Install New Slider Assembly and Endplate.

- ① If necessary, reassemble bumper as shown before installing slider assembly.

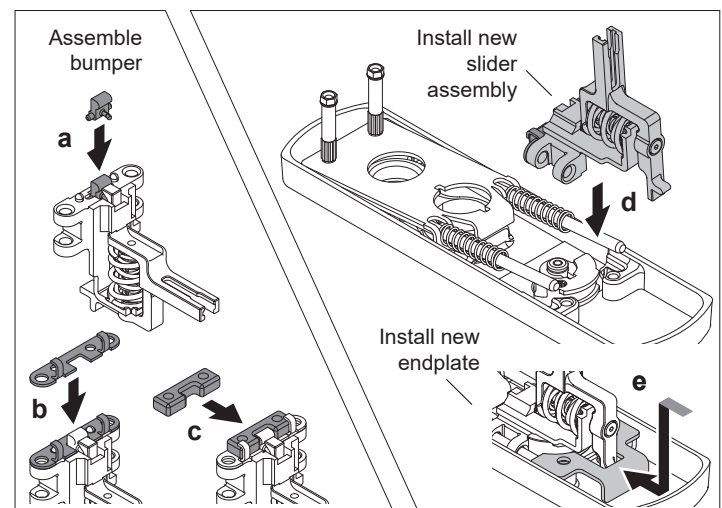

4 Reinstall and Tighten Mounting Screws.

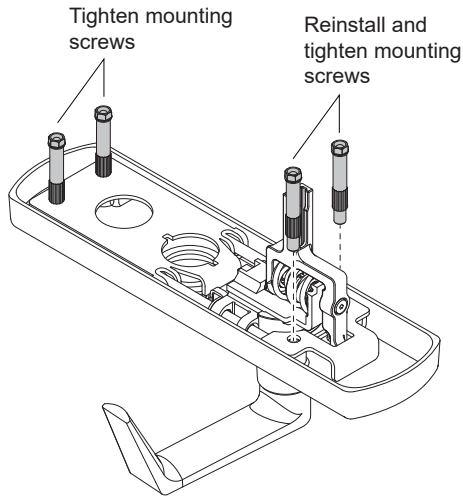

5 Remove Rear Mounting Bracket from Mechanism Case and Dispose.

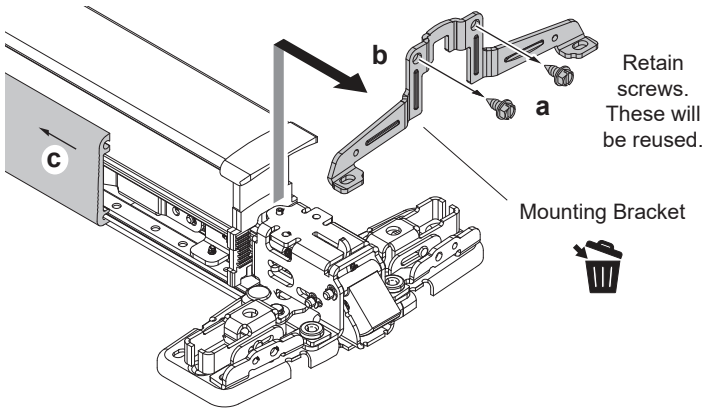

6 Remove Center Case from Mechanism Case and Dispose.

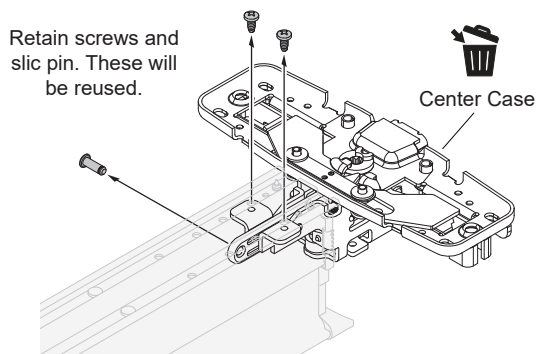

7 Install New Center Case and Rear Bracket.

- Attach baseplate to new center case with 2 screws and a slic pin.
- Install new rear bracket.
- Slide mechanism case cover up against rear bracket.
- Secure rear bracket to cover with 2 screws.

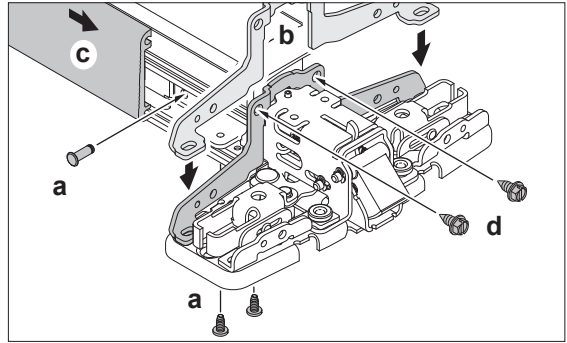

8 For Mortise Devices Only, Door Modification is Required.

Door Preparation for Mortise Applications

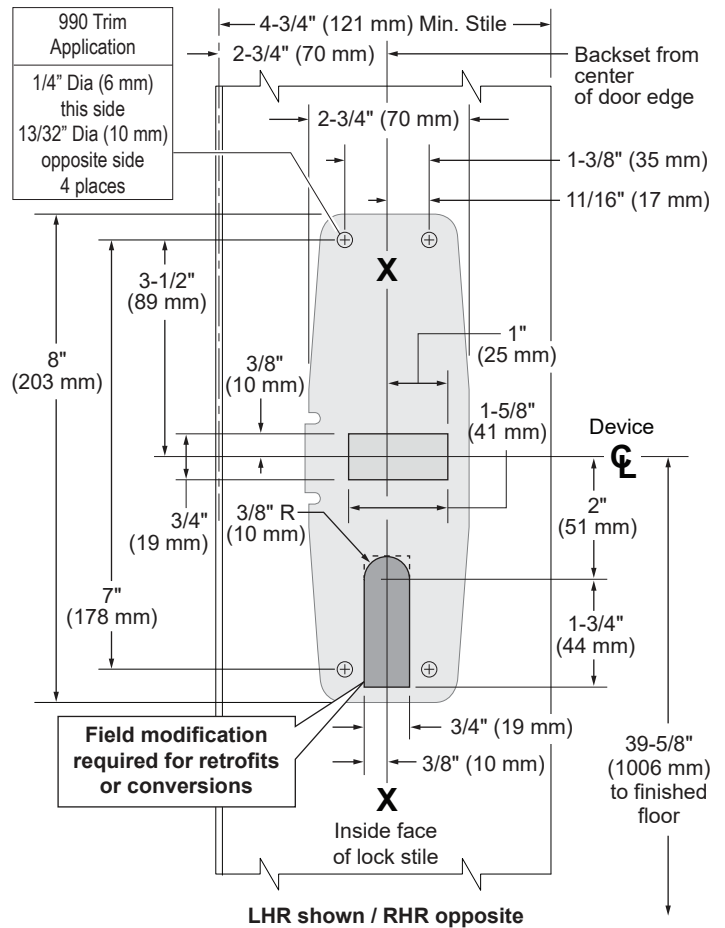

9 Return to Beginning of Instruction and Follow Installation Steps on Pages 1 - 3.

Customer Service

1-877-671-7011 www.allegion.com/us



© Allegion 2023
Printed in U.S.A.
47640278 Rev. 08/23-b