



# VR810/VR814

# IVES

829653-00

Vandal Resistant Trim

Installation Instructions

For use with XX and 18 Monarch Rim and Surface Vertical Devices

## 1 Prepare push side of door for exit device.

① See exit device instructions for preparation.

## 2 Prepare pull side of door for trim.

2a Transfer vertical and horizontal device center lines from push side of door to pull side.

2b Locate and prepare all holes as indicated below.

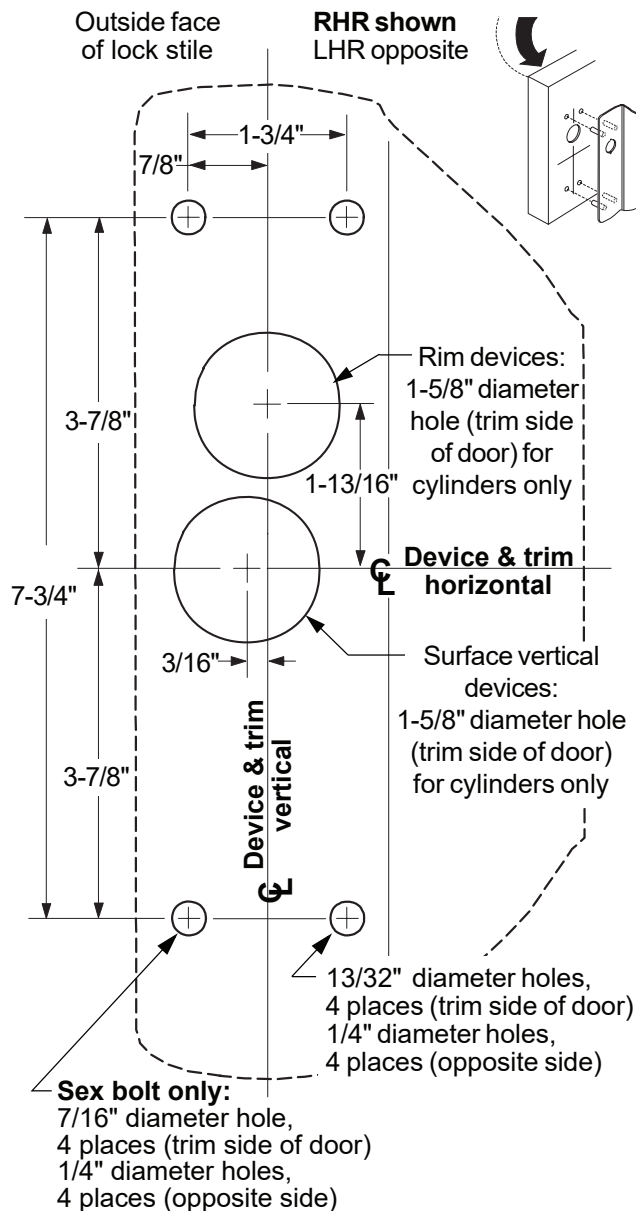

## 3 If using a cylinder:

3a Secure cylinder to trim.

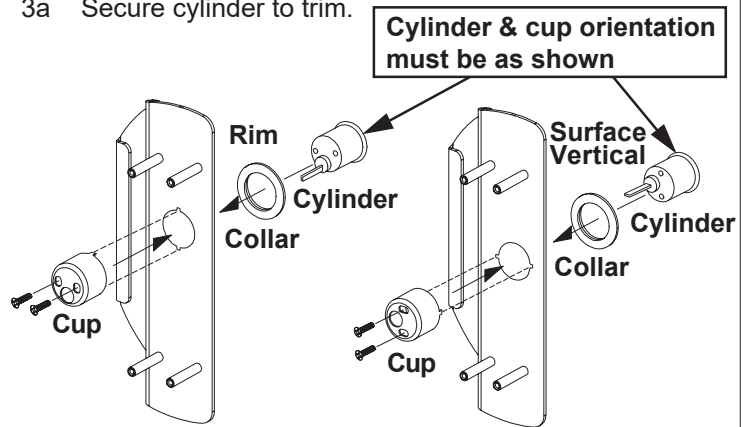

3b Place trim on door and cut cylinder tailpiece so it projects 1/2" out of door.

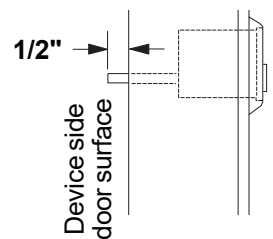

## 4 Install exit device and trim.

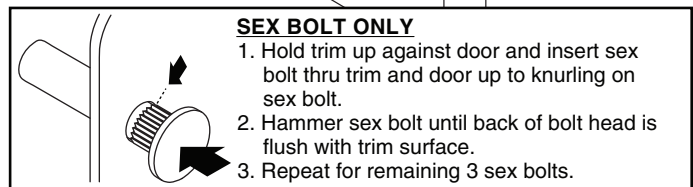
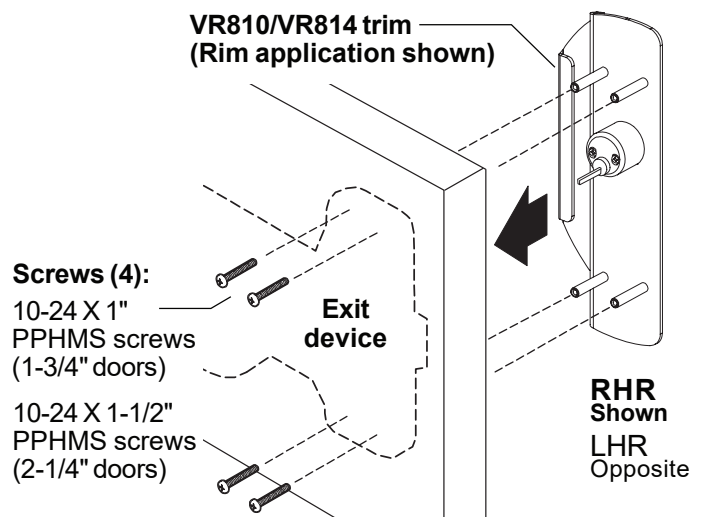

Customer Service

1-877-671-7011

www.allegion.com



© Allegion 2020  
Printed in U.S.A.  
829653-00 Rev. 09/20-c

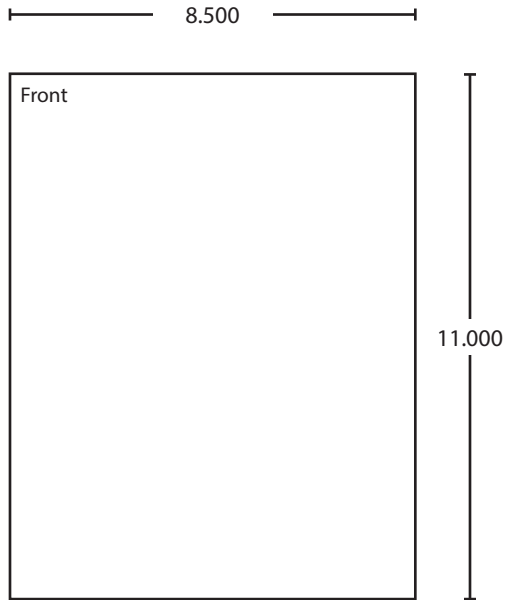

BEGINNING SHEET

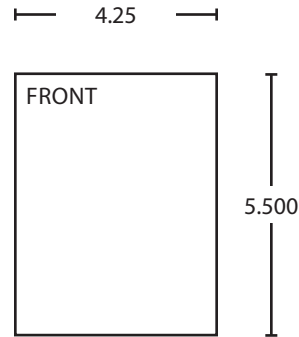

FOLDED SHEET

Additional Notes:
1. None

Revision History						Revision Description: C > Revision					
A	B	C	D	E	F						
xxxxx		085429									
Material White Paper						Edited By D. Rollison		Approved By M. Roberts		EC Number 085429	Release Date 09-22-20
Notes 1. printed one side 2. printed black 3. tolerance ± .13 4. printed in country may vary 5. drawings not to scale						Title Ives VR810/VR814 Installation Instructions					
						Creation Date xx-xx-xx		Number 829653-00			Revision C
						Created By D. Rollison		Activity 3899 Hancock Expwy Security, CO 80911		© Allegion 2020	
						Software: InDesign CS6					