



941271-00

Replacement Kit

Knob Booster

VON DUPRIN

Installation Instructions

1. Knock out pin to remove old booster assembly.
2. Assemble booster body, spring, and spacer as shown in Figure 1.
3. Slide booster assembly on knob spindle.
4. Insert roll pin through spindle and booster body groove.

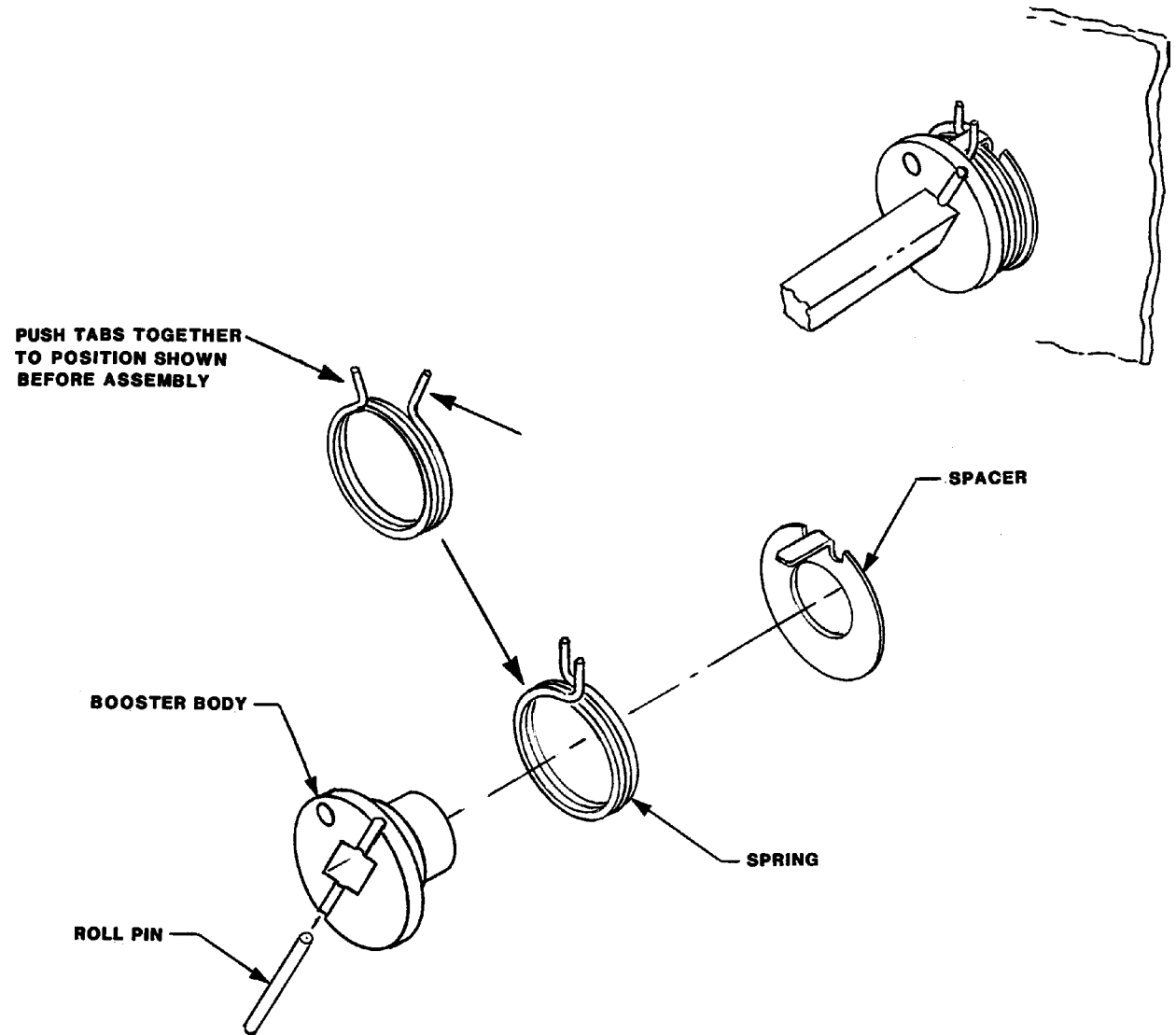

For cutouts on inside face of door,
see exit device instructions

Customer Service

1-877-671-7011

www.allegion.com/us



© Allegion 2014
Printed in U.S.A.
941271-00 Rev. 01/14-b