

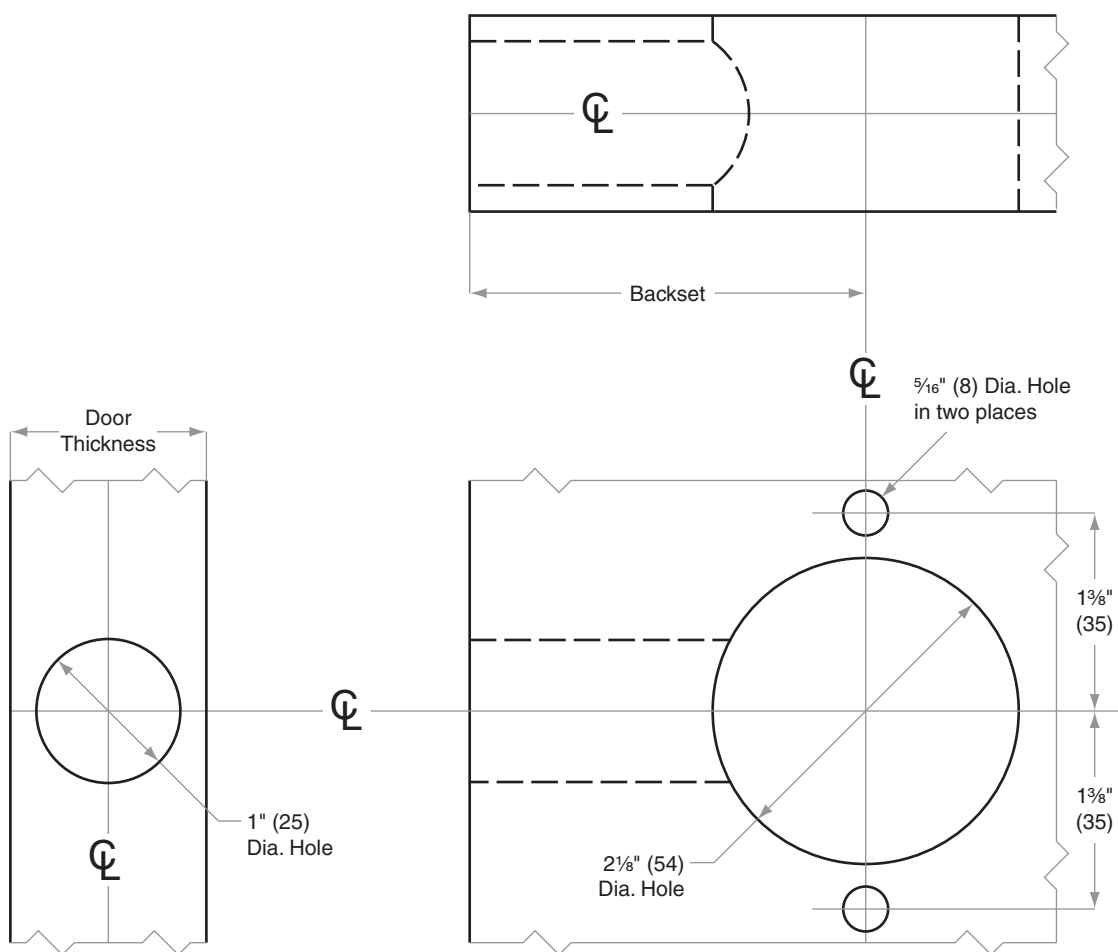

# AL-Series

Models AL10– AL85

Door Type: Wood or Composite, Flat  
Door Thickness:  $1\frac{3}{8}$ " (35 mm)– $1\frac{7}{8}$ " (48 mm)  
Faceplate: Circular Drive-In  
Backsets:  $2\frac{3}{8}$ " (60 mm),  $2\frac{3}{4}$ " (70 mm)



Dimensions shown in parentheses ( ) are in millimeters.

Door preparation template  
**AL893**