

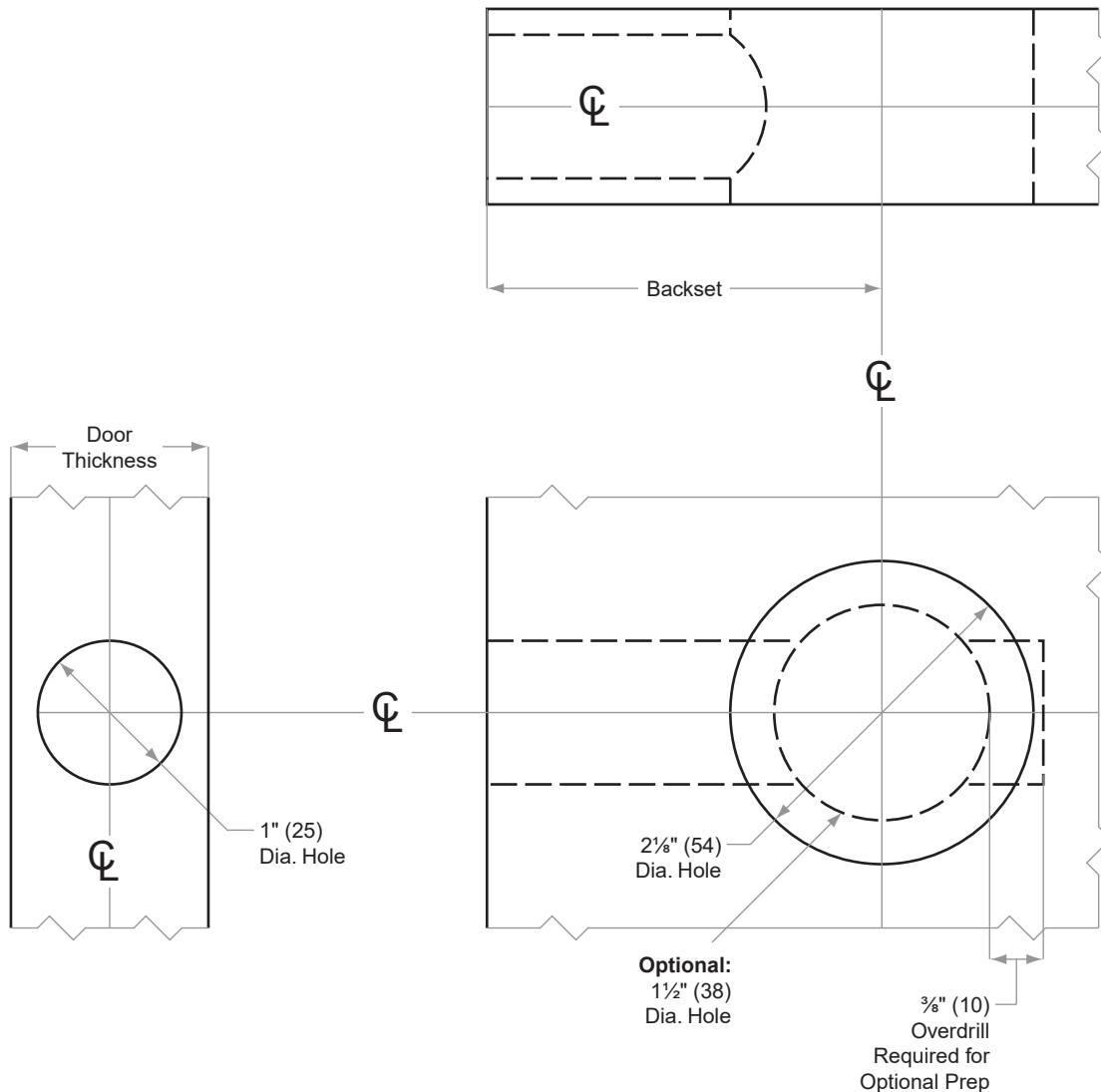

B500-Series

Models B560, B561, B562, B563

- Door Type: Wood or Composite, Flat
- Door Thickness: 1 $\frac{3}{8}$ " (35 mm)–1 $\frac{7}{8}$ " (48 mm)
- Faceplate: Circular Drive-In
- Backsets: 2 $\frac{3}{8}$ " (60 mm), 2 $\frac{3}{4}$ " (70 mm), 5" (127 mm)



2 $\frac{1}{8}$ " bore required with indicator trim

Dimensions shown in parentheses () are in millimeters.

Door preparation template