

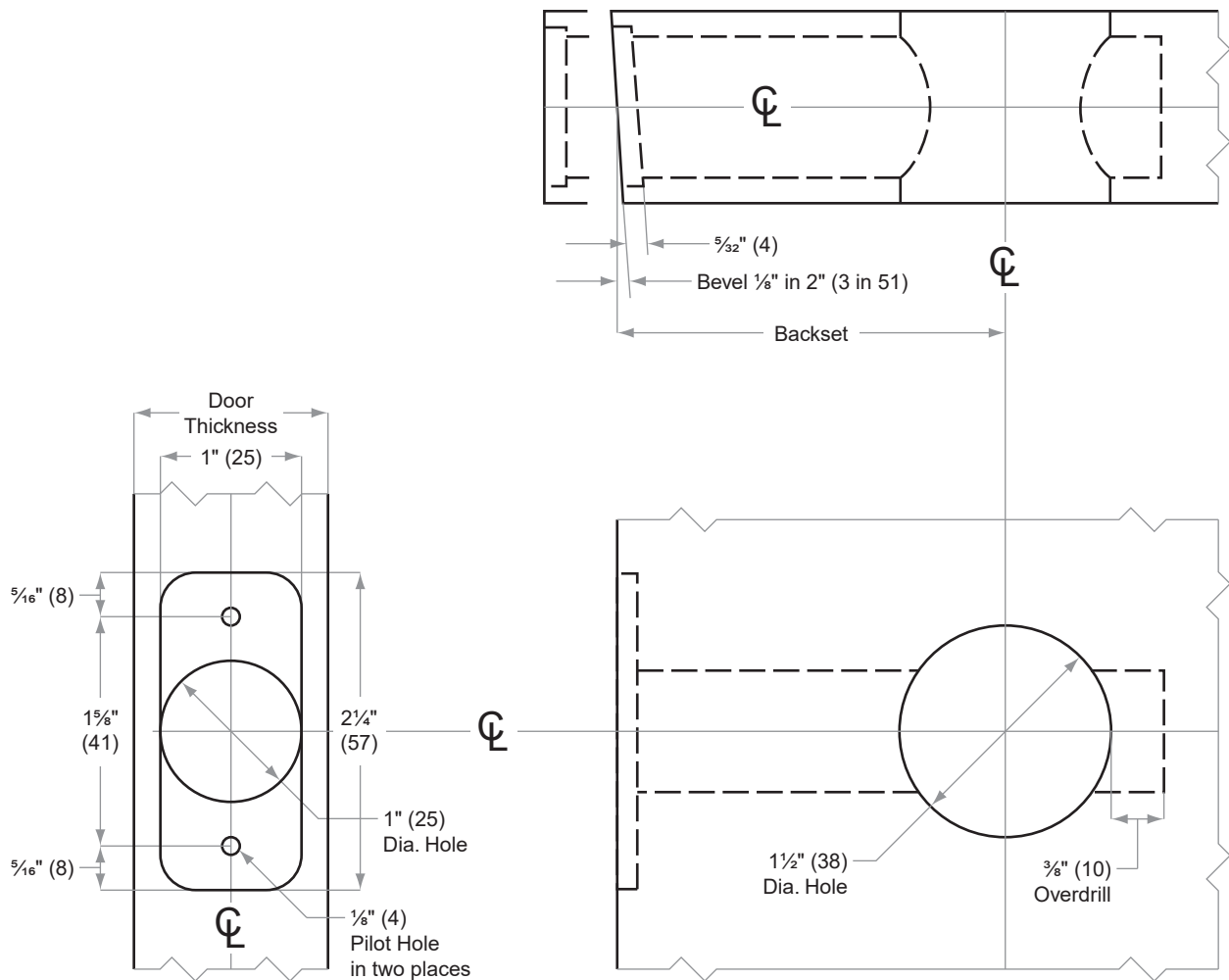

# B500-Series

Models B571, B581

- Door Type: Wood or Composite, Flat or Beveled
- Door Thickness:  $1\frac{1}{8}$ " (35 mm)– $1\frac{3}{8}$ " (48 mm)
- Faceplate: Round Corner,  $\frac{1}{4}$ " (6 mm) Radius, 1" (25 mm) wide
- Backsets:  $2\frac{3}{8}$ " (60 mm),  $2\frac{3}{4}$ " (70 mm), 5" (127 mm)



**$2\frac{1}{8}$ " bore required with indicator trim**

Dimensions shown in parentheses ( ) are in millimeters.

Door preparation template