



# CO-Series

## Model CO-100-CY

Door Type: Metal, Flat or Beveled Conforms to ANSI/BHMA A156.115  
 Door Thickness: 1 $\frac{3}{8}$ " (35 mm) – 2 $\frac{3}{4}$ " (70 mm)  
 Faceplate: Square Corner, 1 $\frac{1}{8}$ " (29 mm) wide  
 Backsets: 2 $\frac{3}{4}$ " (70 mm), 2 $\frac{3}{8}$ " (60 mm), 3 $\frac{3}{4}$ " (95 mm), 5 $\frac{3}{4}$ " (146 mm)

**IMPORTANT - It is critical to identify the interior and exterior sides of door in order to correctly locate the .625" holes**

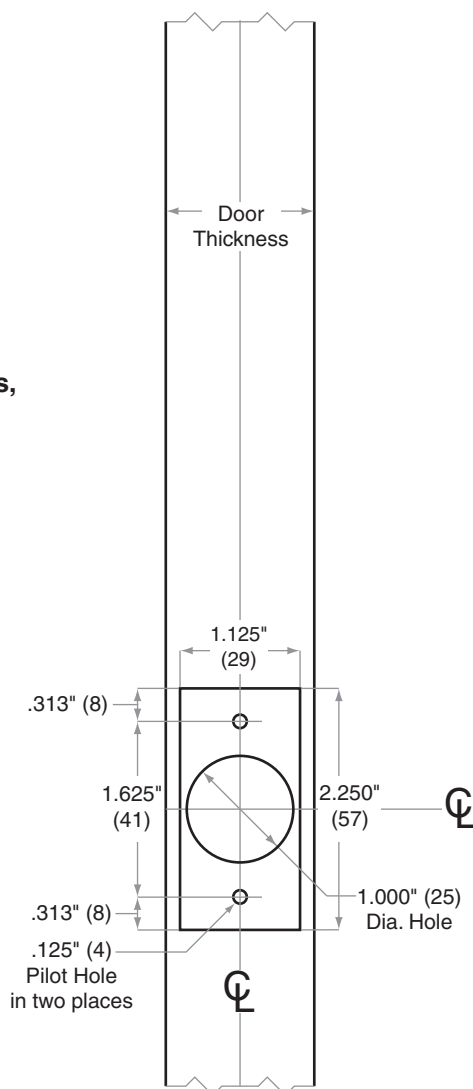
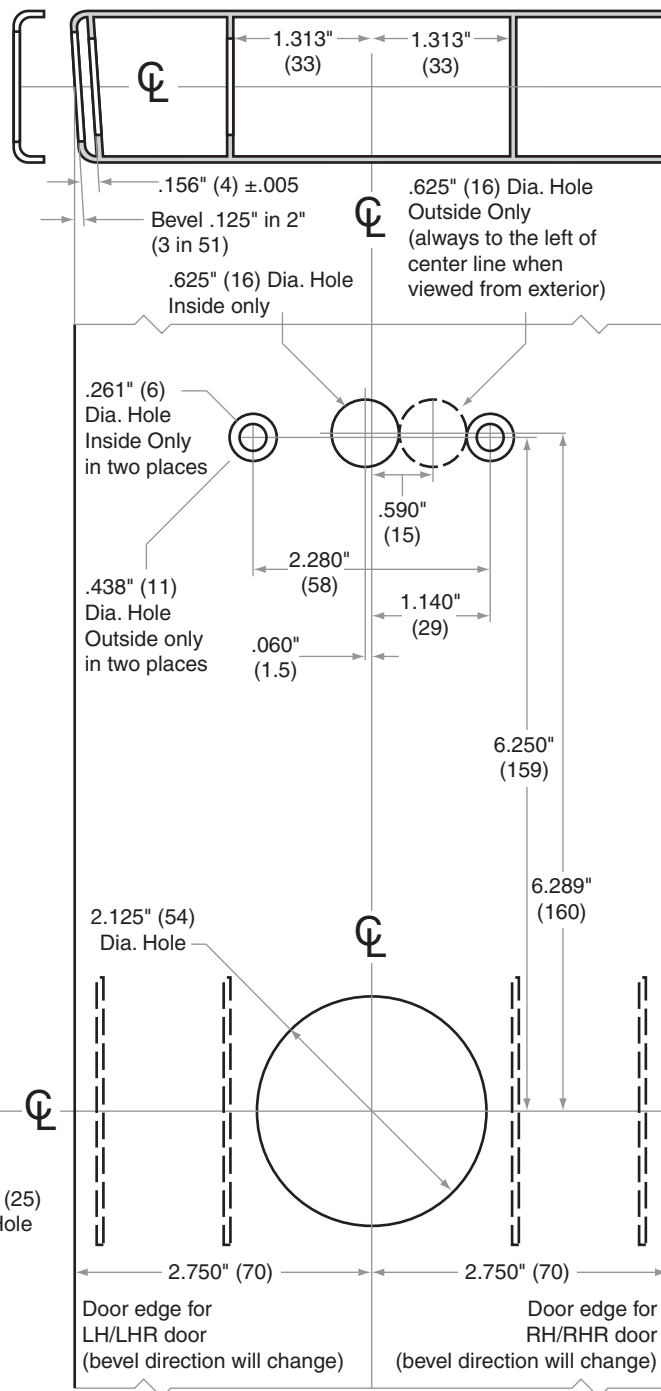

**For Strike dimensions, see Templates J918, J919, J928, and J929**

Dimensions shown in parentheses ( ) are in millimeters.

Door preparation template

# CO102