



# H-Series

H110H, H153H, H180H, H185H

- Door Type: Wood or Composite, Flat
- Door Thickness:  $1\frac{3}{8}$ " (35 mm)– $1\frac{3}{4}$ " (44 mm)
- Faceplate: Circular Drive-In
- Backsets:  $2\frac{3}{8}$ " (60 mm) |  $2\frac{3}{4}$ " (70 mm)

**This template is for use with the adapter ring for a  $2\frac{1}{8}$ " (54) prepped hole, both upper and lower**

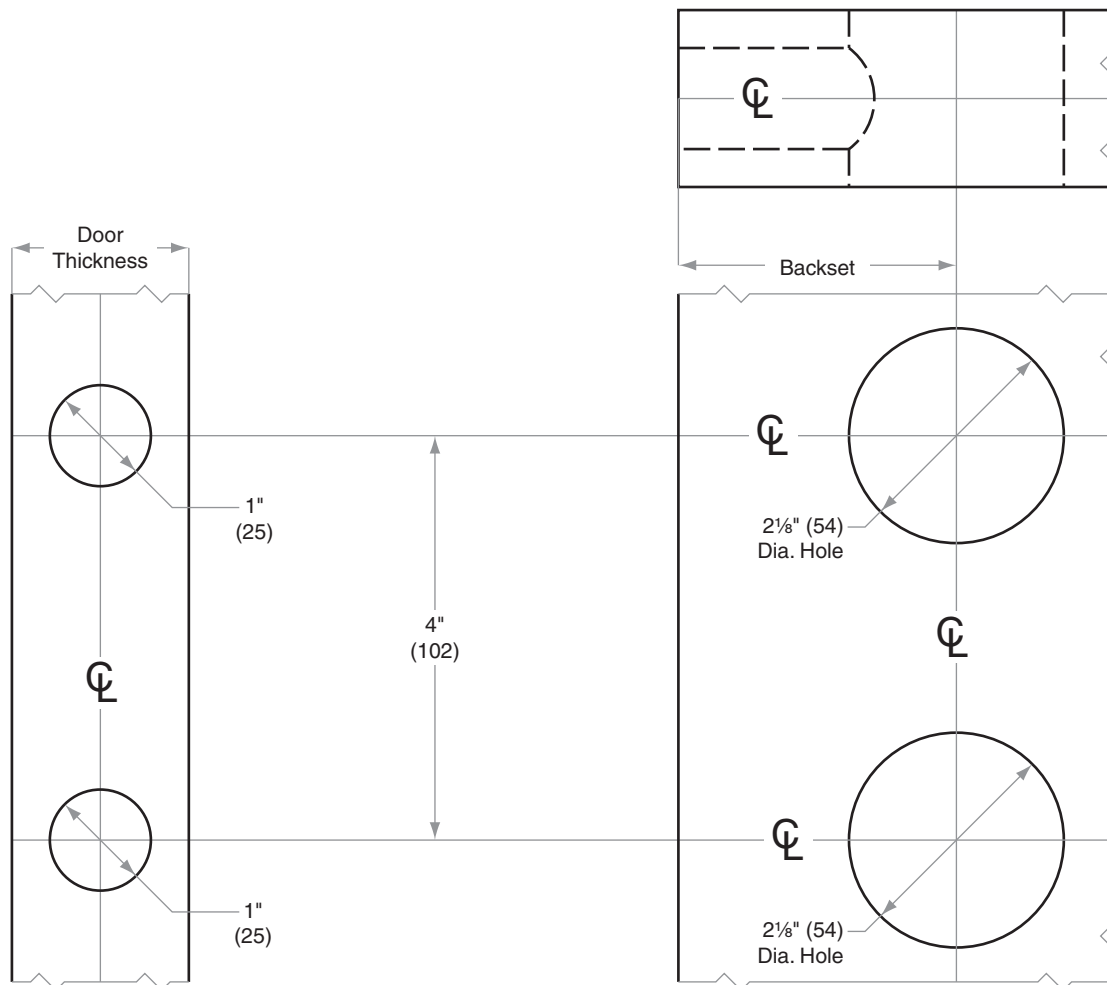

Dimensions shown in parentheses ( ) are in millimeters.

Door preparation template