

# Stairwell Doors

These security recommendations are for doors that lead to stairwells.

 Learn best practices to secure this opening.



## Locate this opening:

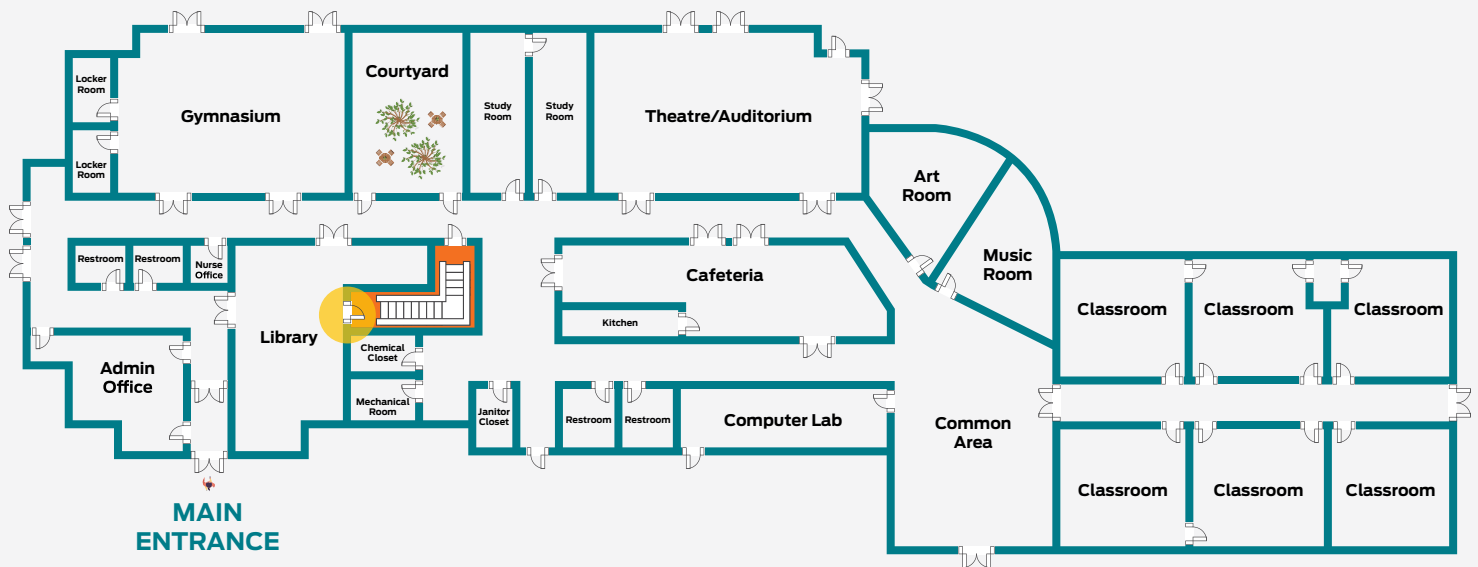

## Operational requirements:



Door is **typically unlocked** but can be locked via a lockdown button to control traffic throughout the building or in case of emergencies



May be required to **unlock upon fire alarm**



Doors can be held open with magnets to allow **ease of passage during the school day**



Free egress into the stairwell is **always available for easy evacuation.**



## Product recommendations

Here are some key components for securing a stairwell.

For full solutions, specifications and recommendations, **contact us**.

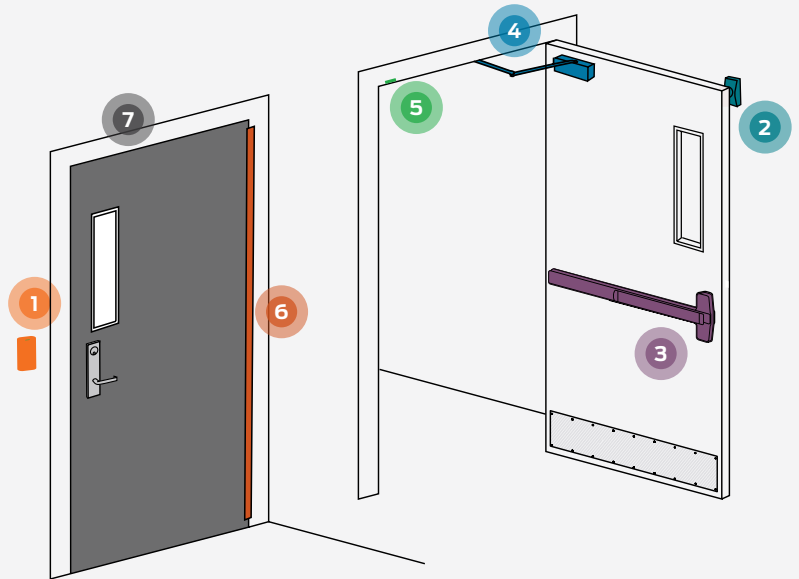

Access controlled doors provide the highest level of security because they can be instantly locked or unlocked depending on the need. They can also be scheduled to lock or unlock at specified times.

-  A **multi-technology reader** allows controlled access of authorized personnel only. Smart **credentials** are recommended for improved key control (eliminating the distribution of keys).
-  **Magnetic hold opens** that release upon command from the security system (lockdown button) and/or fire alarm.
-  **Fail safe fire exit panic hardware** with electrified trim allows the doors to lock quickly if needed, but ensures they meet required codes.
-  A **door closer** is required to ensure door returns to locked, latched and secure position.
-  **Door position switch and latch bolt monitor** allow the central office or other school personnel to know if any doors are not closed and/or latched.
-  Consider **continuous hinges** on these doors for improved durability in this high traffic area.
-  Consider **steel doors and frames** for higher levels of security, durability, and stronger lock reinforcements. Steel doors may also have built-in conduit raceways to make wiring for access control easier.



A power supply with fire alarm input is recommended.

## Security note:

During a lockdown event, these doors would close and lock. However, should the fire alarm sound, these doors would unlock. This functionality is required by the fire code to enable occupants to evacuate the building in case of a fire.

It is recommended that you work with your local authority having jurisdiction to make a plan for securing these areas if the fire alarm is activated during a lockdown.

## Code considerations:

- Depending on the adopted codes, stairwell doors are typically required to be fire door assemblies and will have fire exit hardware when serving an area with an occupant load of 50 or more (100 or more for NFPA).
- Interior stairwell doors can be locked on the stair side to help prevent access to upper floors, but stairwell reentry requirements must be met.
- These requirements are intended to allow building occupants to leave a stairwell if it becomes compromised during a fire, through doors that are normally locked.
- Although under certain circumstances NFPA 101 – Life Safety Code allows interior stair doors to be locked on the stair side with mechanical locks, the International Building Code (IBC) requires all lockable interior stair doors to have the capability of remote unlocking.
- In most jurisdictions, these locks must be fail-safe electrified locks, or fail-safe electrified trim for fire exit hardware.

## Recommendations from commission reports:

The following security recommendations are from past incident reports and the security industry.

- Stairwells are often less monitored than other areas, allowing for mischief. Consider electronic surveillance in corridors, hallways, stairwells or other areas to securely monitor those areas when natural surveillance is not available. <sup>(Sandy Hook page 56)</sup>
- To help first responders gain access to an incident scene in the most efficient manner, schools can collaborate with local first responders to apply a common numbering system to the walls, doors (interior, exterior, and non-access), roof hatches and stairwells. <sup>(MSD)</sup>
- During an active-shooter event, limiting the intruder's travel through the school can save lives. <sup>(MSD)</sup>



To contact an Allegion security consultant, visit  
**[us.allegion.com/schoolsecurity](https://us.allegion.com/schoolsecurity)**

### About Allegion

Allegion (NYSE: ALLE) is a global pioneer in seamless access. We keep people and their assets safe, wherever they are, bringing together simple solutions, convenient access and advanced technology.

For more, visit **[www.allegion.com](https://www.allegion.com)**

KRYPTONITE ■ LCN ■  ■ STEELCRAFT ■ VON DUPRIN



**ALLEGION™**

© 2025 Allegion  
015667, Rev. 10/24  
**[www.allegion.com/us](https://www.allegion.com/us)**