



002103-000-70

FALCON®

BEFORE ATTEMPTING TO INSTALL LOCK, READ ALL INSTRUCTIONS AND LAY PARTS OUT AS SHOWN IN FIGURE 7A OR 7B

BORE 1" HOLE (25mm)
PARALLEL TO
SIDES OF DOOR

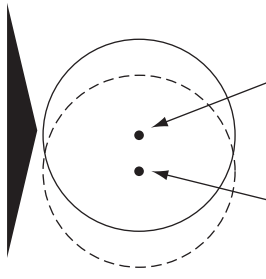

CENTER
FOR 1 3/4"
DOORS
(44mm)

CENTER
FOR 1 3/8"
DOORS
(43mm)

FOLD ALONG EDGE OF DOOR

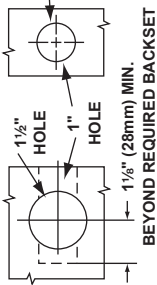

DISTANCE
FROM EDGE
OF DOOR
(BACKSET)



Marking Template for New Installations

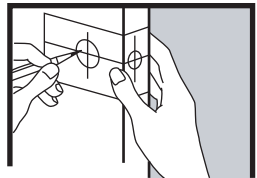
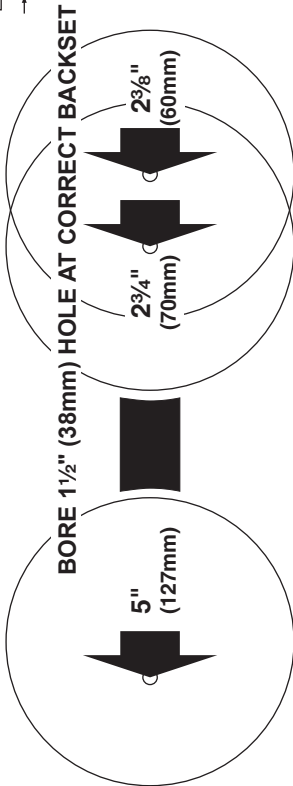

1 Mark centers for latch holes and side holes (follow template instructions)

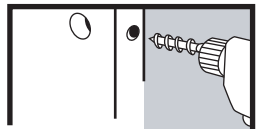

2 Drill 1 1/2" dia. hole in face and 1" dia. hole in edge of door per template instructions

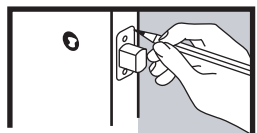

3 Insert latch in edge keeping its face parallel to face of door. Mark outline of latch face and remove latch

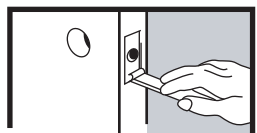

4 Chisel 5/32" (3.97mm) deep or until latch face is flush with door edge.

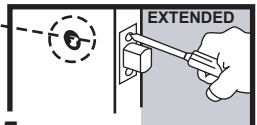
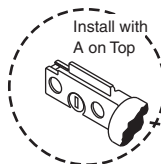

5 Insert latch and secure with two (2) No. 7 x 3/4" wood screws. Tighten screws.



ALLEGION

© Allegion 2014
Printed in U.S.A.
002103-000-70 Rev. 10/14-d

IMPORTANT: EXTEND DEADBOLT BEFORE PROCEEDING

6 TRIM ASSEMBLY

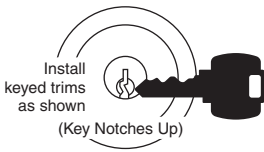

Small rings (F) are used only on 1 3/8" thick doors

7A SINGLE CYLINDER ASSEMBLY

Optional Interchangeable Core

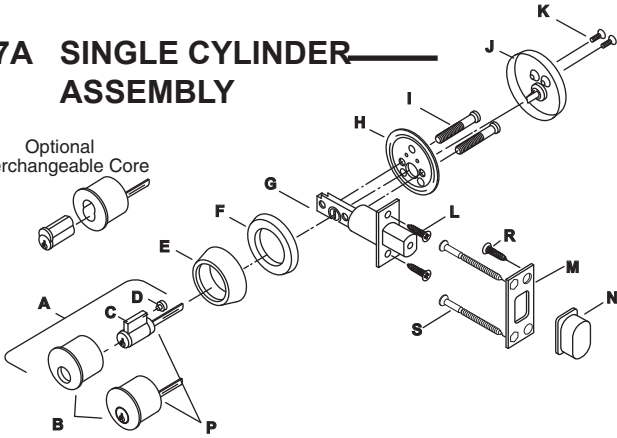

Single Cylinder Screw 1/4" bolts (I) through plate* (H) into housing (B) & tighten. Engage tailpiece (P) with thumbturn (J). Fasten thumbturn (J) to plate (H) with short machine screws (K)

NOTE Align plate with the large holes below the small holes as shown

7B DOUBLE CYLINDER ASSEMBLY

Optional Interchangeable Core

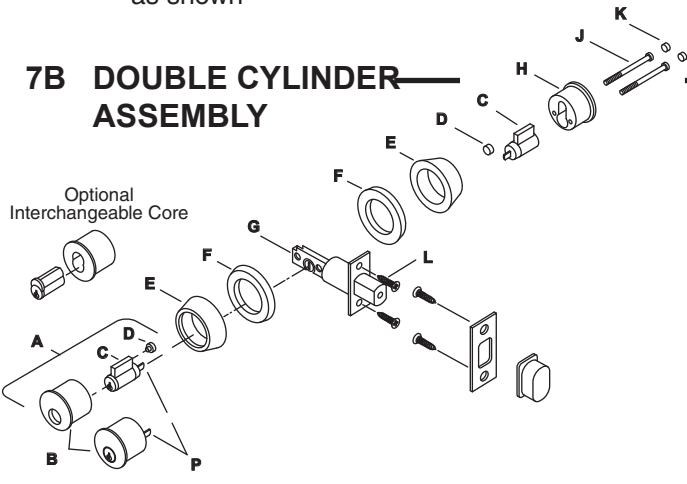

Double Cylinder Screw 1/4" bolts (J) through housing (H), and ring (E) into housing (B) engaging tailpieces (P) with the vertical slot in the deadbolt

Important: Check locking and unlocking of both sides with door open before snapping covers (K) over bolts (J).

8. STRIKE INSTALLATION

A Mark the corners of the deadbolt with crayon or grease pencil. Retract deadbolt and close door. Throw dead bolt firmly against jamb to transfer markings.

B Bore 1" diameter hole 1 1/8" deep centered between the markings. *CAUTION: Deadbolt will not function correctly if hole is too shallow.*

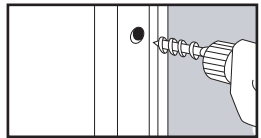

C Place strike on jamb, centering over hole and parallel to edge of frame. Mark outline and remove strike.



D Chisel cutout 1/16" deep for standard strike. Chisel cutout 1/8" deep for optional strike.

OPTIONAL STRIKE

E Center strike (M) over hole with small holes (S) away from door stop. Install 2 small screws (S). Check locking function before installing longer screws.

F Drill 2 pilot holes (O) 3" deep to prevent splitting of jamb and install 3" long screws (O) in large holes next to door jamb

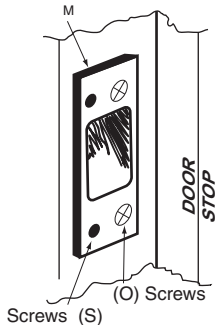

STANDARD STRIKE

G Install strike with No. 7 x 3/4" screws. Tighten screws.



4.250



12.500

4.250

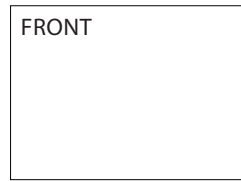

3.125

FOLDED SHEET

BEGINNING SHEET

Additional Notes:
1. None

Revision History						Revision Description:				
A	B	C	D	E	F	D > Revised artwork				
FAL	0790	6683								
Material						Edited By	Approved By	EC Number	Release Date	
50# offset or equivalent						J. Ellis	M. Roberts	xxxxx	10/14	
Notes						Title				
1. printed both sides						Falcon Marking Template for New Installations				
2. printed black						Creation Date	Number		Revision	
3. tolerance ± .13						10-22-14	002103-000-70		D	
4. printed in country may vary						Created By	Activity			
5. barcode shows after folding						J. Ellis	3899 Hancock Expwy Security, CO 80911			
						Software: InDesign CS6			© Allegion 2014	