

Schlage knobs and levers

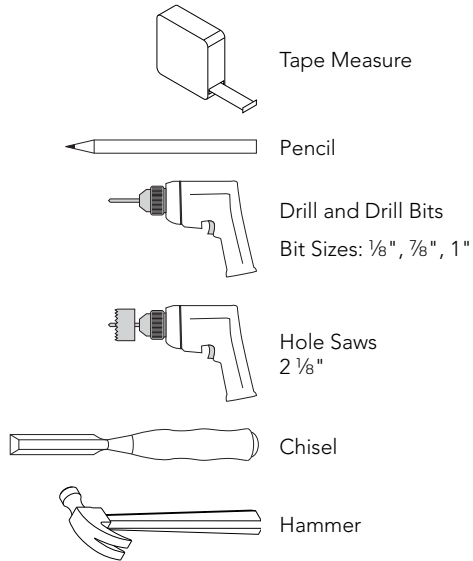

Door Preparation Instructions for Door with No Holes

Tools Needed



1 Measure door thickness.

If the door is thinner than $1\frac{3}{8}$ " or thicker than $1\frac{3}{4}$ ", then the lock will not fit properly on the door.

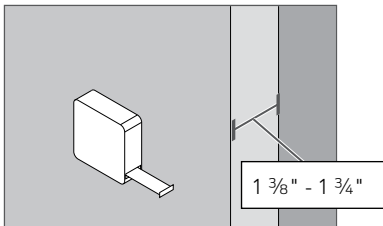

2 Mark lock centerline.

2a Mark centerline on door face, door edge and door jamb.

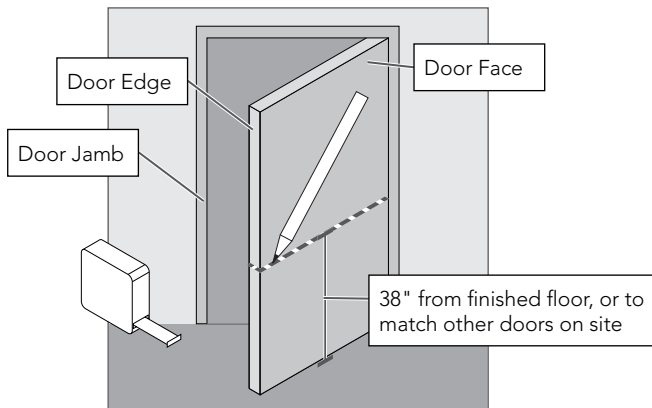

3 Prepare cross bore.

3a Measure backset and mark center of hole.

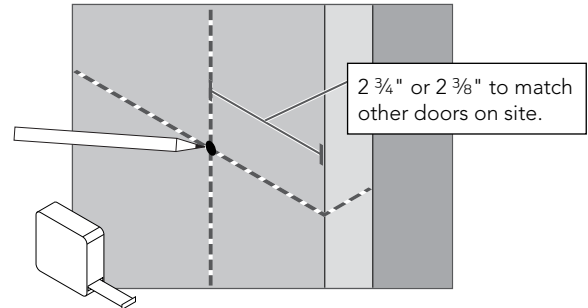

3b Drill hole with hole saw.

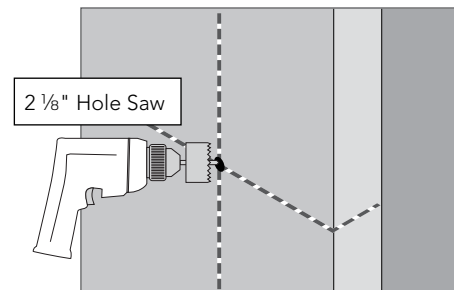

4 Prepare door edge hole.

4a Measure and mark $\frac{1}{2}$ " door thickness.

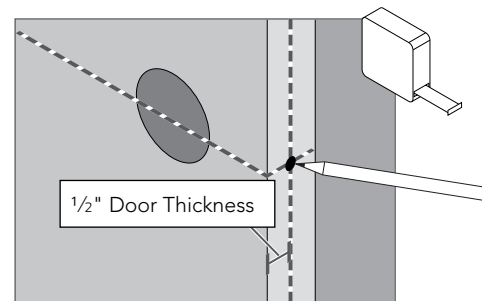

4b Drill hole in door edge.

Mortise faceplate

Circular drive-in faceplate

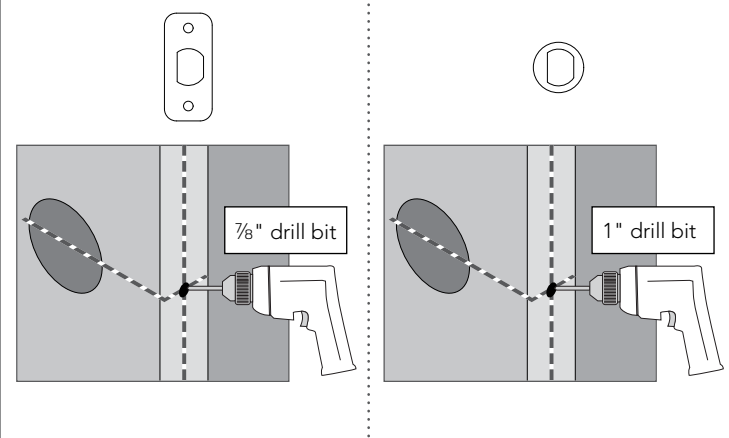

5 Mortise for latch.

① Skip this section for circular drive-in faceplate.

5a Insert latch into door edge hole. Trace latch faceplate and mark holes.

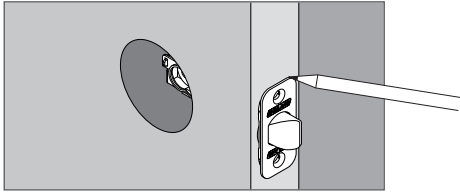

5b Remove latch. Drill two (2) 1/8" pilot holes.

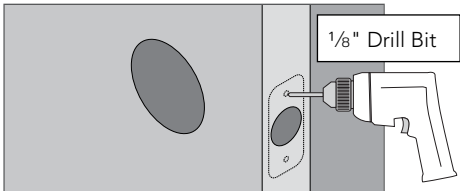

5c Use chisel and hammer to create 1 1/8" mortise for latch.

① Latch must be flush with door edge.

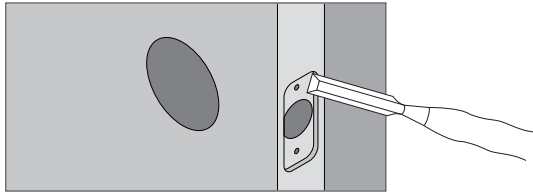

6 Measure, mark and drill holes in door jamb for strike.

6a Mark center for strike hole exactly opposite latch hole.

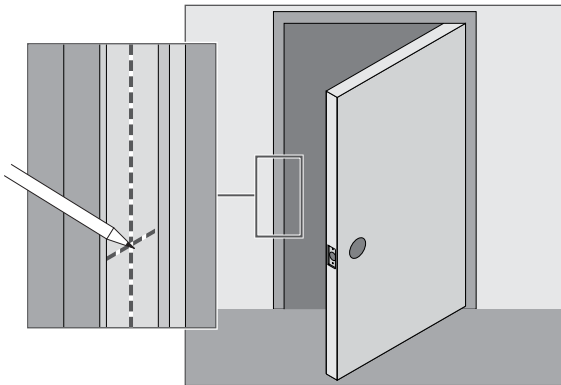

6b For the strike, mark and drill 1" hole, 1/2" deep, as shown.

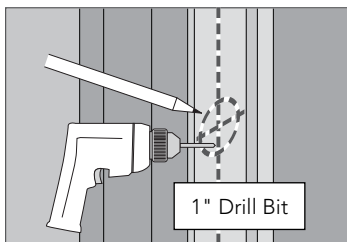

7 Mortise for strike.

7a Trace latch strike. Mark holes.

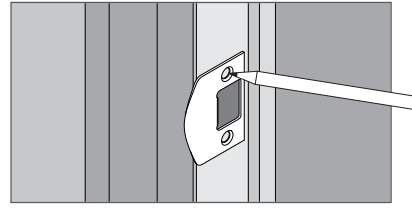

7b Drill two (2) 1/8" pilot holes.

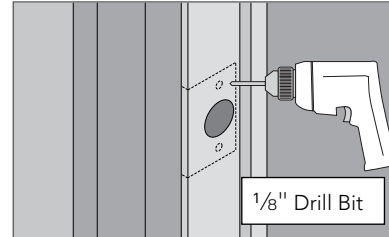

7c Use chisel and hammer to create a 1/16" mortise for the strike.

① Cut the mortise so the strike extends all the way to the edge of the jamb to allow for the latch lip.

