

### AL & D-Series Lever Locks

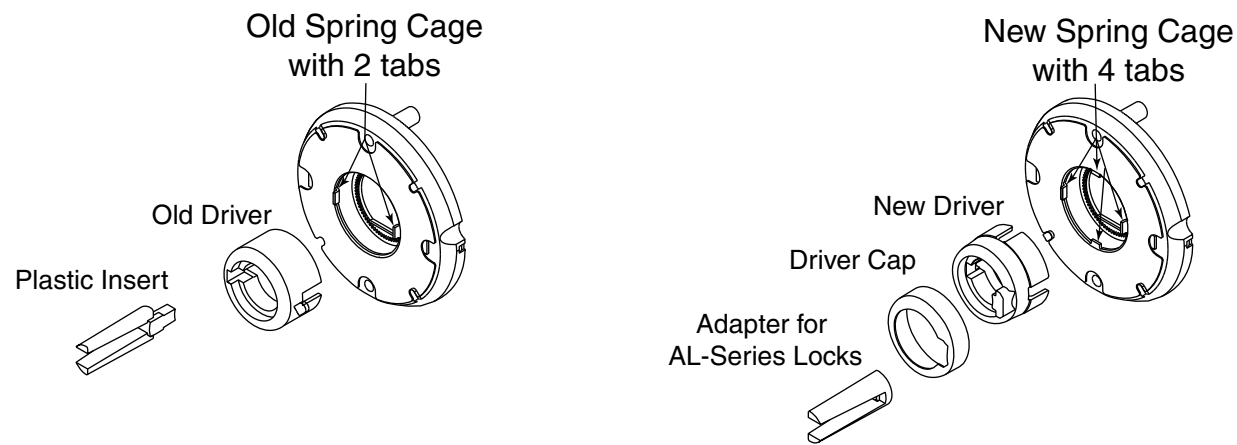

#### Tools Required

**For Lock Installation**  
Phillips screwdriver  
Catch push pin or Spanner wrench.  
Castle nut wrench

#### Remove Inside Trim

**1**

#### 1. Remove INSIDE LEVER and INSERT.

**NOTE:** Some locks manufactured in the year 2000 or later do not have plastic lever inserts.

**FOR NON-KEYED LOCKS**  
a. Insert pointed end of catch push pin or other tool (e.g. spanner wrench) into hole in lever.  
b. Push tool in to depress catch.  
c. Pull lever from spindle.

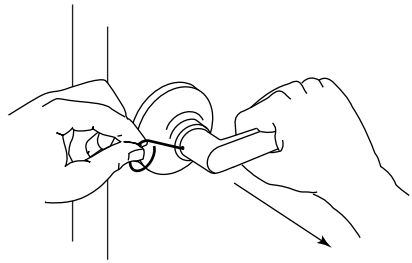

**FOR KEYED LOCKS**  
a. Insert key into cylinder.  
b. Turn key one-quarter (1/4) turn.  
c. Insert pointed end of catch push pin or other tool (e.g. spanner wrench) into hole in lever.  
d. Push tool in to depress catch.  
e. Pull lever from spindle.

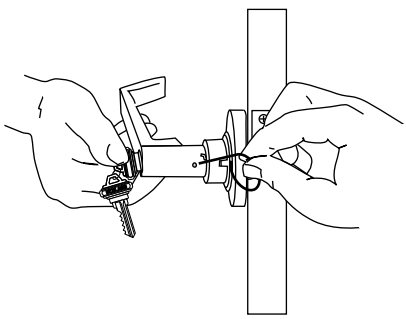

#### 2. Remove ROSE from chassis.

To remove rose, twist rose counterclockwise on chassis.

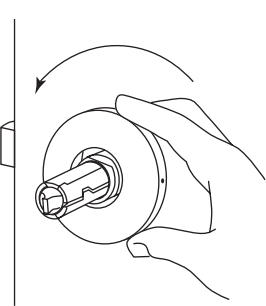

#### 3. Remove DRIVER from chassis.

Pull driver off spindle.

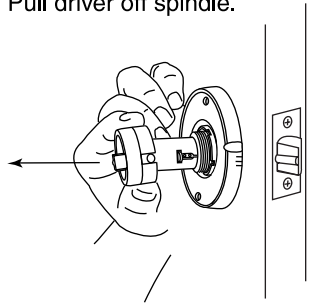

#### 4. Remove CASTLE NUT.

Using a castle nut wrench, unscrew and remove the castle nut.

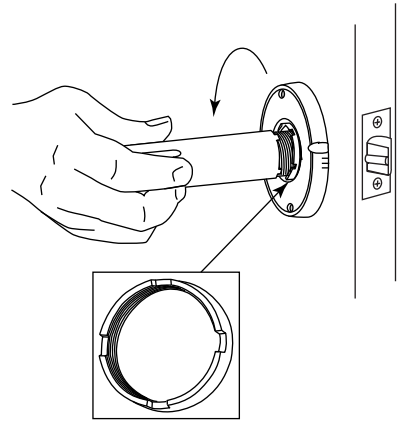

**CAUTION:** Once the inside spring cage screws are removed, the outside trim will become loose.

#### 5. Remove two (2) SPRING CAGE screws.

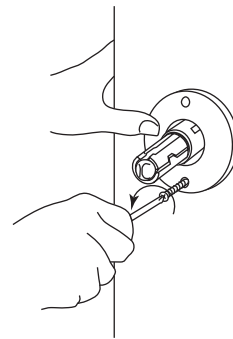

#### 6. Remove INSIDE SPRING CAGE.

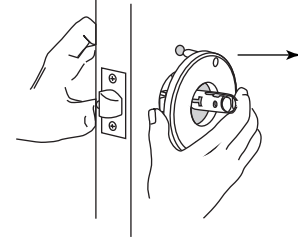

#### 2. Remove and discard the PLASTIC LEVER INSERT.

**NOTE:** Some locks manufactured in the year 2000 or later do not have plastic lever inserts.

#### 3. Remove DRIVER from chassis and discard.

a. Pull driver off spindle.  
b. Discard old driver.

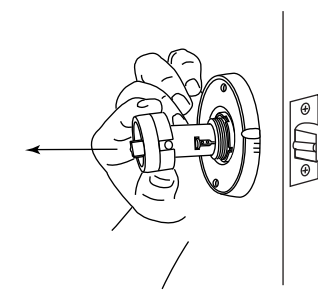

#### 4. Pull CHASSIS from door.

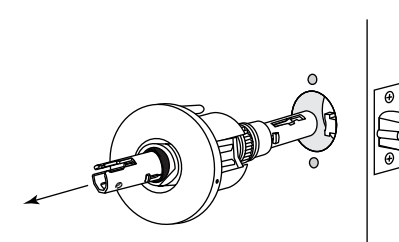

#### 5. Remove OUTSIDE ROSE from chassis.

a. Place a flat-tipped screwdriver into the cutout between back of rose and spring cage.  
b. Push the screwdriver into the cutout and remove rose from spring cage.

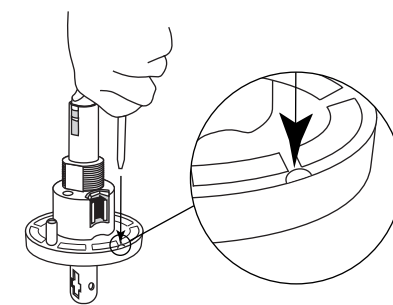

#### 6. Remove CASTLE NUT.

Using a castle nut wrench, unscrew and remove the castle nut.

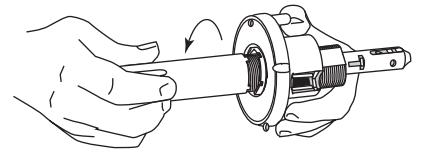

#### 7. Remove OUTSIDE SPRING CAGE and discard.

**IMPORTANT:** Continue on to SECTION 3 for D-Series locks. Continue on to SECTION 4 for AL-Series locks.

### D-Series Door Thickness Adjustment

**3**

**NOTE:** The standard door thickness is 1 inch.

#### 1. Install NEW OUTSIDE SPRING CAGE.

**NOTE:** The outside spring cage screw posts are threaded.

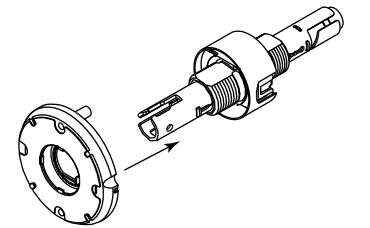

#### 2. Install CASTLE NUT.

Using a castle nut wrench, rotate castle nut clockwise until about four (4) threads of the chassis hub are showing.

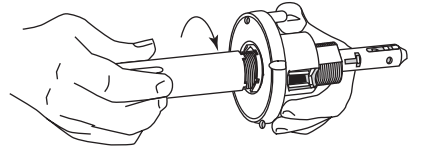

#### 3. Adjust for DOOR THICKNESS.

a. Place the chassis against a flat surface with the spring cage hanging from the bottom of the chassis.  
b. Place template against the spring cage to find marking for door thickness.

**NOTE:** Use the template markings to measure adjustment BEFORE installing lock on door.

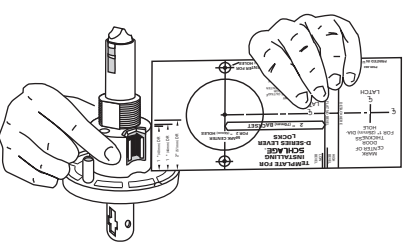

c. Use castle nut wrench to rotate castle nut in the direction of adjustment.

#### 4. Continue on to SECTION 5.

### AL-Series Door Thickness Adjustment

**4**

**NOTE:** The standard door thickness is 1 inch.

#### 1. Check ANCHOR SPRING.

Make sure the ANCHOR SPRING (except on AL25) is installed over the outside spindle.

#### 2. Install NEW OUTSIDE SPRING CAGE.

**NOTE:** The outside spring cage screw posts are threaded.

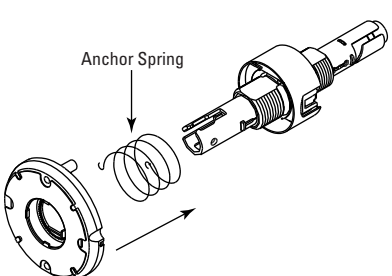

#### 3. Install CASTLE NUT.

Using a castle nut wrench, rotate castle nut clockwise until about three (3) threads of the chassis hub are showing.

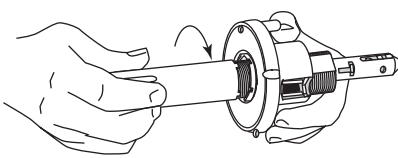

#### 4. Adjust for DOOR THICKNESS.

Using a castle nut wrench, rotate the castle nut until screw post lines up with the correct door thickness mark.

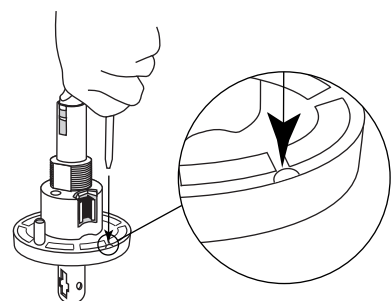

#### 5. Continue on to SECTION 5.

### Install Outside Trim

**5**

#### 1. Install OUTSIDE ROSE.

a. Align dimple of rose with small notch in spring cage.  
b. Snap rose into place. Rose should fit snugly.

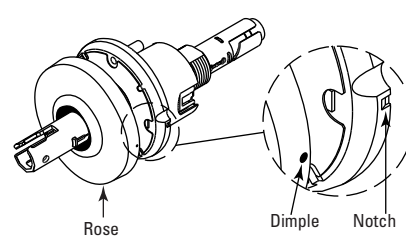

#### 2. Slide CHASSIS into door.

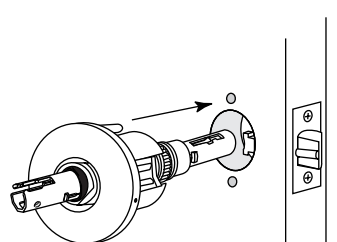

#### 3. Check LATCH PRONGS.

Latch prongs should engage chassis housing, and the latch retractor should engage the latch bar.

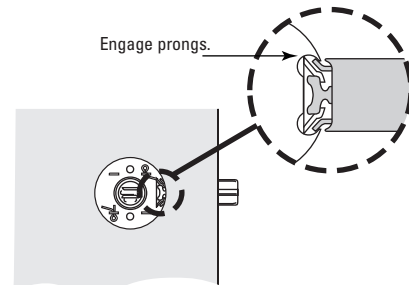

#### 4. Install NEW DRIVER and CAP.

**FOR AL-SERIES LOCKS**  
a. Place the driver cap and plastic adapter onto the driver.  
b. Align the slot on the driver with the catch on the spindle and slide into place.

**FOR D-SERIES LOCKS**  
a. Place the driver cap onto the driver.  
b. Align the slot on the driver with the catch on the spindle and slide into place.

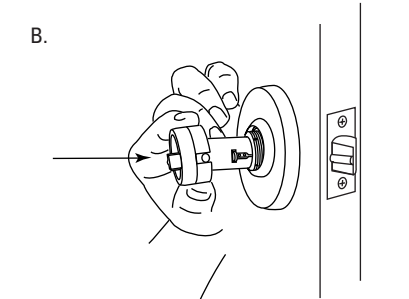
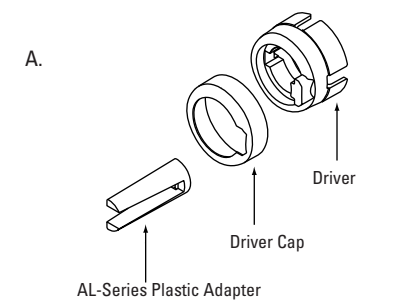

#### 5. Install OUTSIDE LEVER.

**FOR KEYED LOCKS**  
a. Insert cylinder into lever.  
b. Insert key into cylinder.  
c. Begin to slide lever onto spindle.  
d. Rotate key one-quarter (1/4) turn and continue to slide the lever into place until a "click" is heard.  
e. Pull on lever to ensure catch is fully engaged.

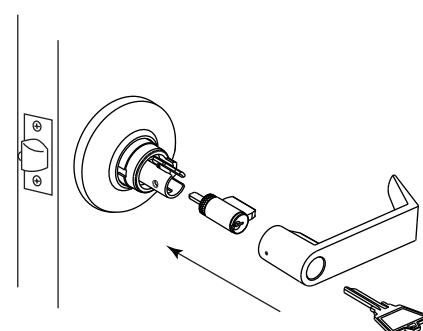

**FOR NON-KEYED LOCKS**  
a. Slide lever onto spindle until a "click" is heard.  
b. Pull on lever to ensure catch is fully engaged.

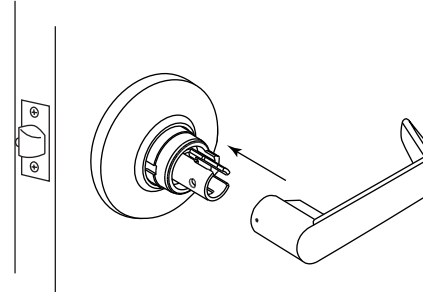

### Install Inside Trim

#### 1. Install INSIDE SPRING CAGE.

While holding the outside trim in the door, install inside spring cage.

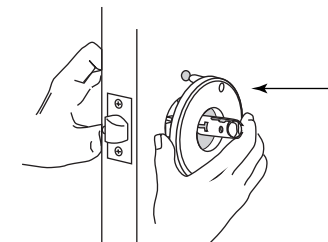

#### 2. Install two (2) SPRING CAGE SCREWS.

Do not overtighten.

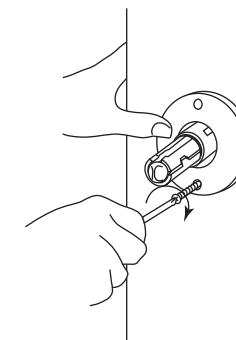

#### 3. Install CASTLE NUT.

a. Thread castle nut onto chassis.  
b. Using a castle nut wrench, tighten the castle nut. (A ratcheting sound will be heard.)

**NOTE:** DO NOT overtighten the castle nut. A metal door can collapse (oilcan) when the lock is overtightened on the door.

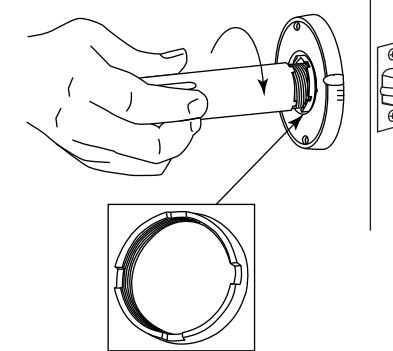

#### 4. Lock CASTLE NUT.

Loosen the two (2) spring cage screws slightly (less than one-quarter (1/4) of a turn). This action locks the castle nut in place.

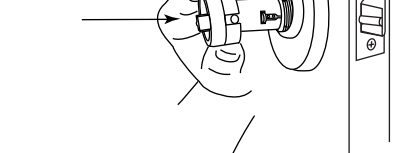
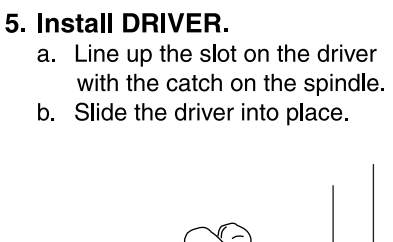

#### 6. Install ROSE.

a. Align dimples on rose with grooves on the spring cage.  
b. Push rose into place and rotate clockwise until it no longer turns.

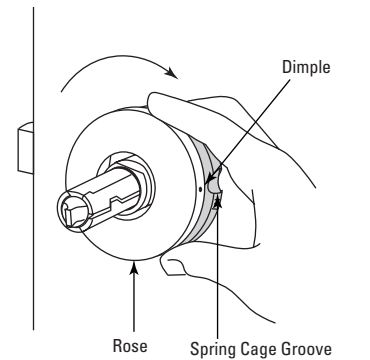

#### 7. Install INSIDE LEVER.

**FOR KEYED LOCKS**  
a. Insert cylinder into lever.  
b. Insert key into cylinder.  
c. Begin to slide lever onto spindle.  
d. Rotate key one-quarter (1/4) turn and continue to slide the lever into place until a "click" is heard.  
e. Pull on lever to ensure catch is fully engaged.

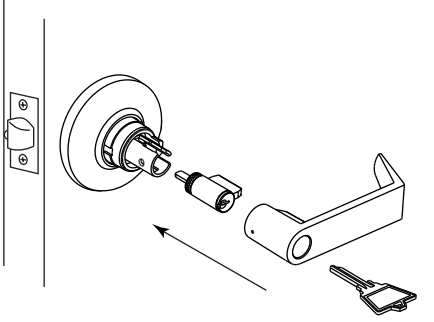

**FOR NON-KEYED LOCKS**

a. Slide lever onto spindle until a "click" is heard.  
b. Pull on lever to ensure catch is fully engaged.

